

6F0055204

SEAT

Accesorios originales SEAT
 SEAT Original Zubehör
 SEAT Genuine Accessories
 Accessori originali SEAT
 Accessoires SEAT d'origine
 SEAT 5W O J O T G R c T b L G S E A T L X X Z G W b
 SEAT »è Û ð æ Þ Þ è â ð ì ò Û î
 Acessórios originais SEAT
 SEAT origineel toebehoren
 Originální p ísluženství SEAT
 Originalne akcesoria SEAT
 SEAT 原裝配件

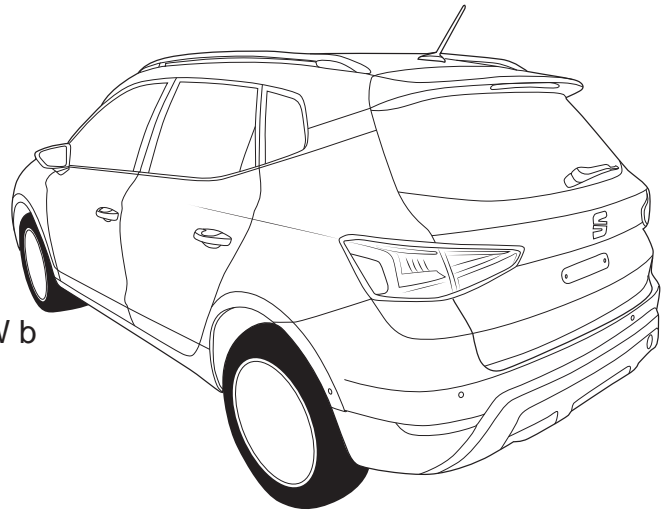

Instrucciones de montaje
 Montageanleitung
 Fitting instructions
 Istruzioni per il montaggio
 Notice de montage
 /TXYWZQ]of VU ZXYG 安裝說明書

Í á ä ä Ü ä î Ã ä ç Þ ñ Û ð ñ Þ ð ä î
 Manual de montagem
 Montagehandleiding
 0 R Q W Ò ñ Þ Q Ò Y R G
 , Q V W U X N F M D P R Q W D I X

ARONA 2018 >

Partes incluidas
 Inkludierte Teile
 Components included
 Parti incluse
 Pièces comprises
 1 U S V U T L T Y b I \ U K f ` O L
 ð ò é í Þ Ì Þ á æ á ù é â è Þ
 Peças incluídas
 Inbegrepen onderdelen
 Zahnuté díly
 ' R V W D U F] R Q H F] K F L
 嵌入部件

Herramientas necesarias
 Erforderliche Werkzeuge
 Required tools
 Utensili necessari
 Outils nécessaires
 4 L U H \ U K O S b L O T X Y W Z S L T Y b
 ç í Þ Ì Þ Û ñ ä ñ Þ ä î à Þ è ä Û Þ
 Ferramentas necessárias
 Vereiste gereedschappen
 Potebné nástroje
 : \ P D J D Q H Q D U] G] L D
 所需工具

Colores ô î û é þ ñ þ
 Farben Cores
 Colours Kleuren
 Colori % D U H Y Q Î P
 Couleurs . R O R U R Z D ø
 9 G H R O J G J I L Y U H ø • N i

| | | | |
|-------------------|-----------------|-------------------|----------------------|
| (ES) BU Azul | (DE) BU % O D X | (GB) BU % O X H | (IT) BU % O X |
| BK Negro | BK Schwarz | BK % O D F N | BK Nero |
| BN Marrón | BN % U D X Q | BN % U R Z Q | BN Marrone |
| GN Verde | GN Grün | GN Green | GN Verde |
| GY Gris | GY Grau | GY Grey | GY Grigio |
| OG Naranja | OG Orange | OG Orange | OG Arancione |
| RD Rojo | RD Rot | RD Red | RD Rosso |
| WH % O D Q F R | WH Weiß | WH White | WH % L D Q F R |
| YE Amarillo | YE Gelb | YE Yellow | YE Giallo |
| PK Rosa | PK Rosa | PK Pink | PK Rosa |
| PE Púrpura | PE Purpur | PE Purple | PE Rosso porpora |
| DL Azul oscuro | DL Dunkelblau | DL Dark blue | DL % O X V F X U R |
| DG Verde oscuro | DG Dunkelgrün | DG Dark green | DG Verde scuro |
| LB Azul claro | LB Hellblau | LB Light blue | LB % O X F K L D U R |
| LG Verde claro | LG Hellgrün | LG Light green | LG Verde chiaro |
| NL Color natural | NL Naturfarben | NL Natural colour | NL Colori naturali |
| SB Azul cielo | SB Himmelblau | SB Sky blue | SB Celeste |
| T Amarillo-marrón | T Gelbbraun | T Yellow brown | T Giallomarrone |
| VT Violeta | VT Violett | VT Violet | VT Viola |

| | | | |
|----------------------|----------------------------------|--------------------------------|-------------------|
| (FR) BU % O H X | (RU) BU 8 O T O P | (GR) BU É í è â | (PT) BU Azul |
| BK Noir | BK > L W T b P | BK Ê þ ú ï | BK Preto |
| BN Marron | BN 1 U W O ^ T L I b P | BN Ê þ ó Ú | BN Marrom |
| GN Vert | GN . L R L T b P | GN Î î ð ð æ è i | GN Verde |
| GY Gris | GY 8 L W b P | GY Á ç í æ | GY Cinza |
| OG Orange | OG 5 W G T M L I b P | OG Î î ñ i ç Û è æ | OG Laranja |
| RD Rouge | RD 1 W G X T b P | RD Ê ú ç ç æ è i | RD Vermelho |
| WH % O D Q F | WH (L R b P | WH É á ò ç ù | WH % U D Q F R |
| YE Jaune | YE - L R Y b P | YE Ê Û ñ i æ è i | YE Amarelo |
| PK Rose | PK 7 U N U I b P | PK ï i ä | PK Rosa |
| PE Pourpre | PE 6 Z W V Z W T b P | PE Î î ó ò ï ù | PE Púrpura |
| DL % O H X I R Q F Ú | DL 9 L S T U X O T O P | DL Ð Q i ú ï i é V è â | DL Azul escuro |
| DG Vert foncé | DG 9 L S T U N L R L T b P | DL Ð Q i ú ï i V i Ú ð æ | DG Verde escuro |
| LB % O H X F O D L U | LB 8 I L Y R U J U R Z H U L B | EG ' é i æ ç ñ ù é i è â | LB Azul clara |
| LG Vert clair | LG 8 I L Y R U N L R L T b P | EG ' é i æ ç ñ ù V i Ú ð æ ç i | LG Verde clara |
| NL Nature | NL , X Y L X Y I L T T b P | JNL Y Ó ò ð æ ç ù ô î ú é | NL P Cor natural |
| SB % O H X F L H O | SB 4 L H L X T U J U R Z H S B P | SB * þ è Ú ä æ i | SB Azul céu |
| T Marron-jaune | T - L R Y U Q U W O ^ T I I b P | PE Ê Û ñ i æ è i ç þ ó Ú | T Amarelo-torrado |
| VT Violet | VT ; O U R L Y U I b P | VT É i ß | VT Violeta |

| | | | |
|-------------------|--------------------------|----------------------------|--------------|
| (NL) BU % O D X Z | (CZ) BU Modrá | (PL) BU Niebieska | (CN) BU KcHø |
| BK Zwart | BK ÷ H U Q Ò | BK Czarna | BK eWHø |
| BN % U X L Q | BN + Q G Ò | BN % U ö] R Z D | BN / [Hø |
| GN Groen | GN Zelená | GN Zielona | GN E...Hø |
| GY Grijs | GY Šeda | GY Szara | GY 6øHø |
| OG Oranje | OG 2 U D Q n R Y Ò | OG 3 R P D U D 4 F] R Z D | OG 0ßHø |
| RD Rood | RD ý H U Y H Q Ò | RD Czerwona | RD E(Hø |
| WH Wit | WH % þ O Ò | WH % L D 2 D | WH = Hø |
| YE Geel | YE m O X W Ò | YE k ä 2 W D | YE eJHø |
| PK Rosé | PK 5 _ n R Y Ò | PK 5 ä I R Z D | PK C Hø |
| PE Paars | PE Purpurov | PE Purpurowa | PE C±Hø |
| DL Donkerblauw | DL Tmavomodrá | DL Granatowa | DL 4wKcHø |
| DG Donkergroen | DG Tmavozelená | DG Ciemnozielona | DG 4wE...Hø |
| LB Lichtblauw | LB % O H G P R G U Ò | LB Jasnozielona | LB 3ËKcHø |
| LG Lichtgroen | LG 6 Y W O H] H O H Q Ò | LG Jasnozielona | LG 3ËE...Hø |
| NL Naturel | NL 3 I þ U R G Q P | NL % D U Z \ | NL Hp7¼Hø |
| SB Hemelsblauw | SB % O D Q N \ W Q Ò | SB % N L W Q D | SB * KcHø |
| T Geelbruin | T m O X W R K Q Ú G Ò | T k ä 2 W R E U ö] R Z D | eJ/[Hø |
| VT Violet | VT Fialová | VT Fioletowa | VT C±EY øHø |

Info

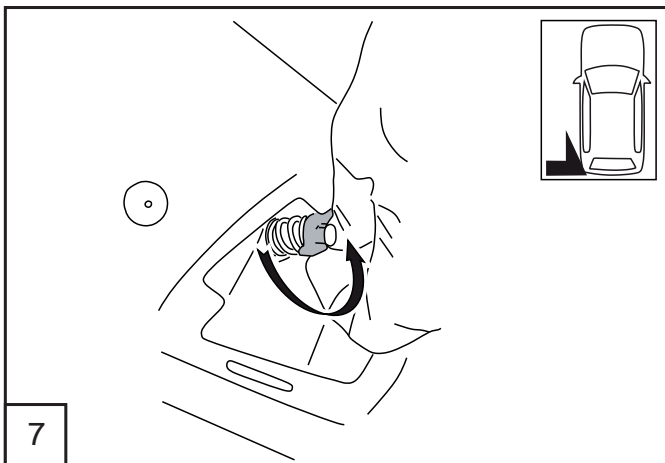
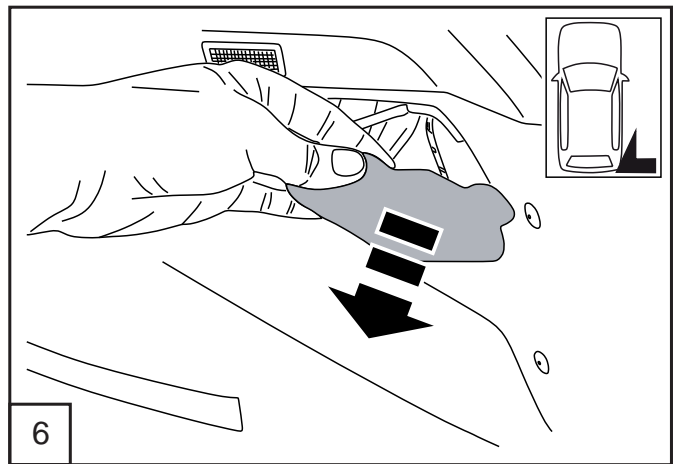
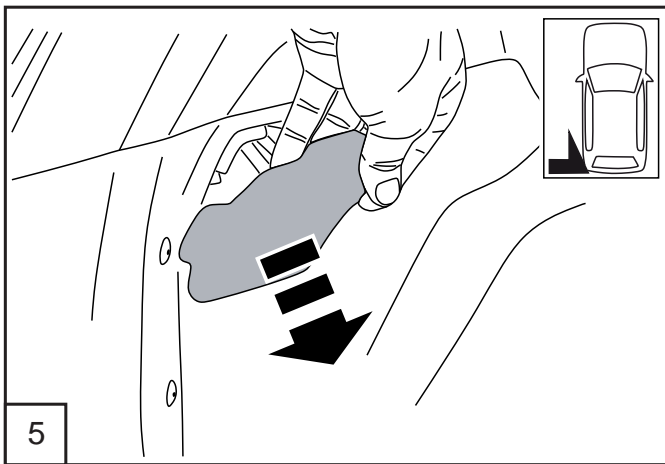
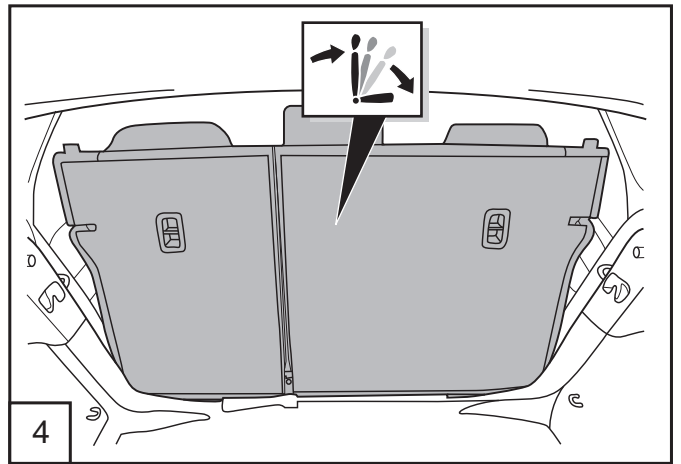
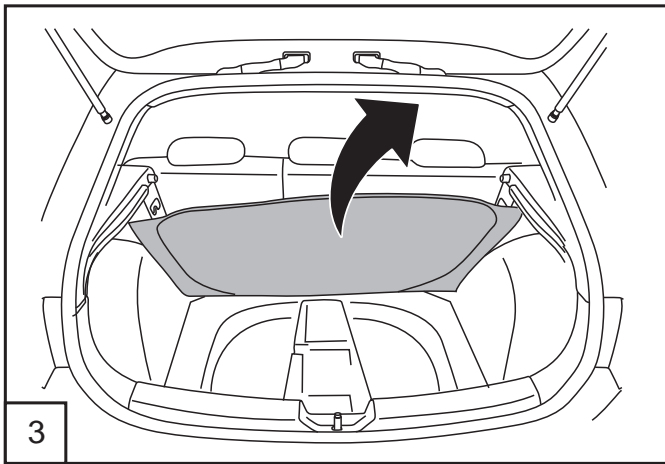
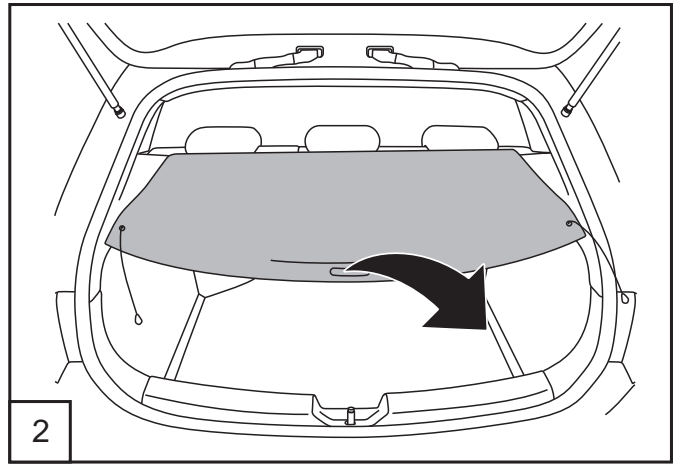
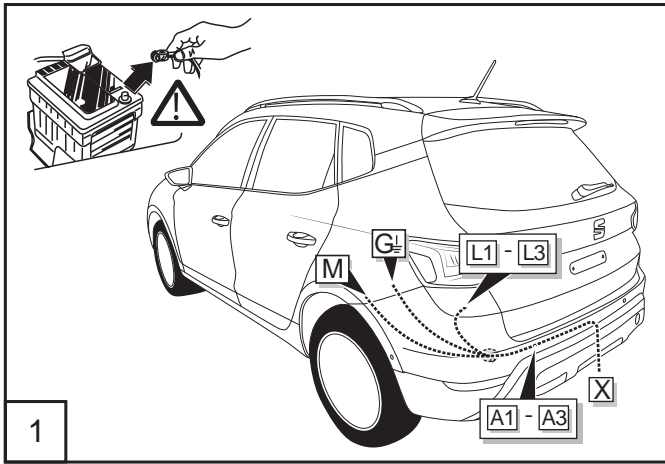

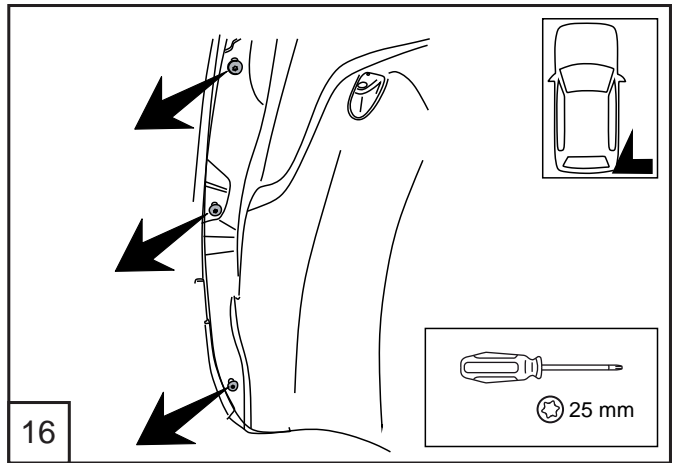
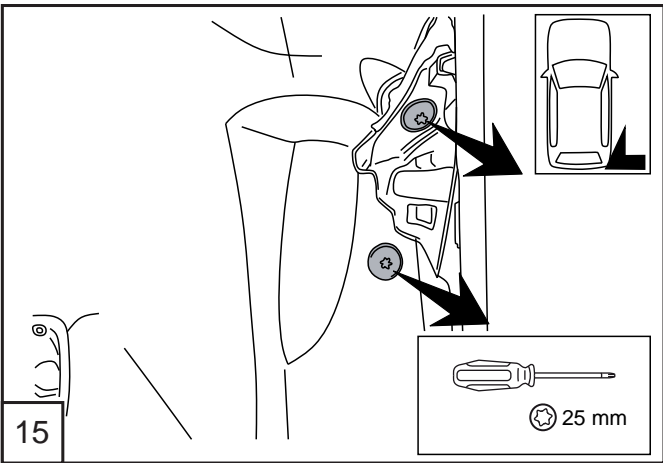
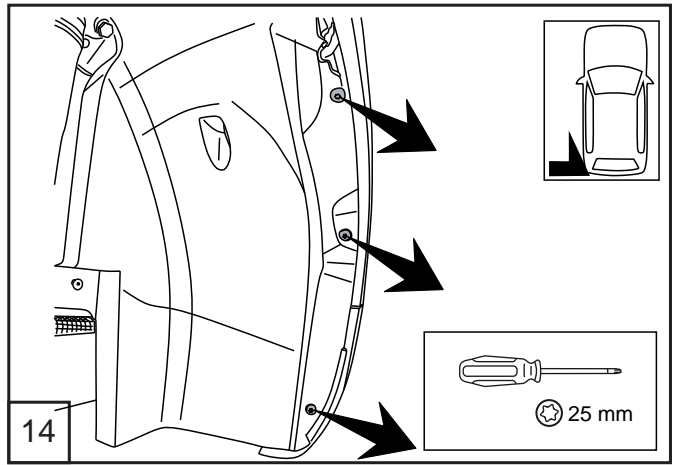
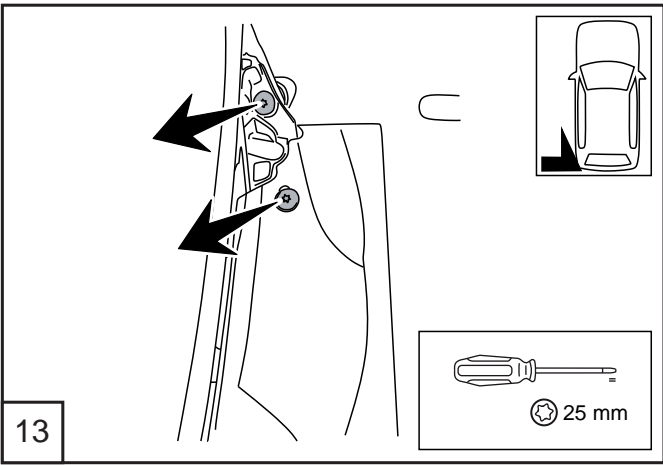
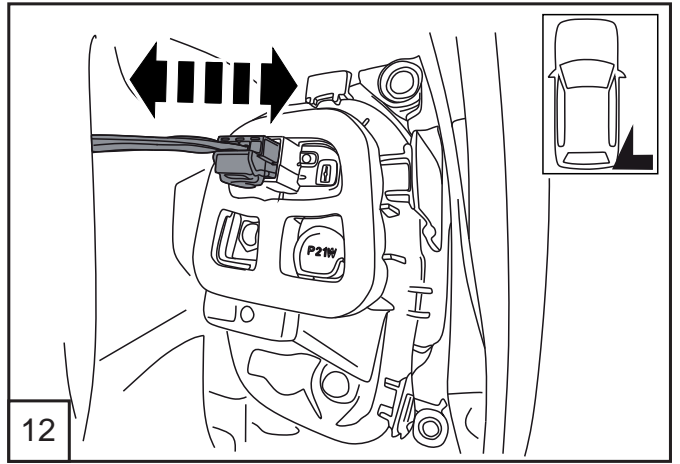
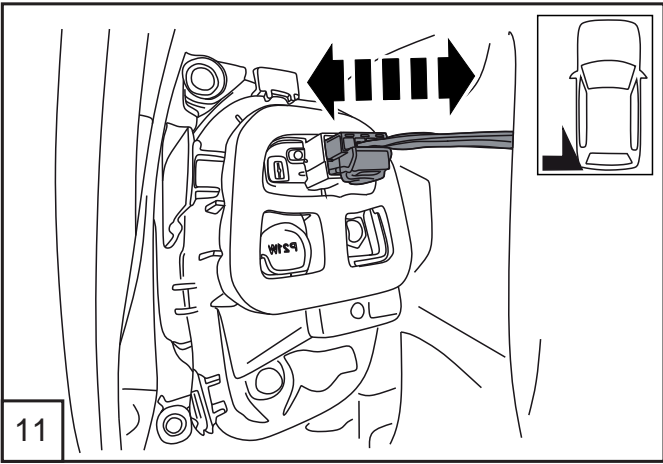
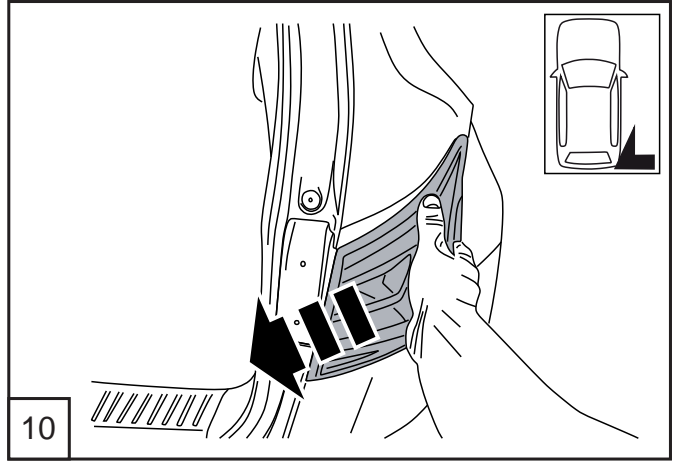
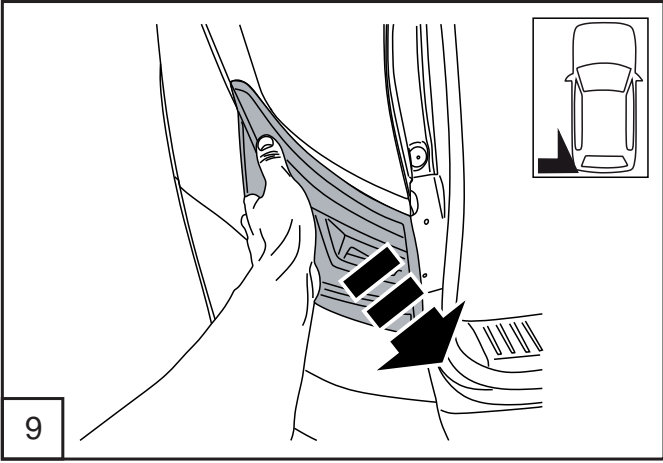

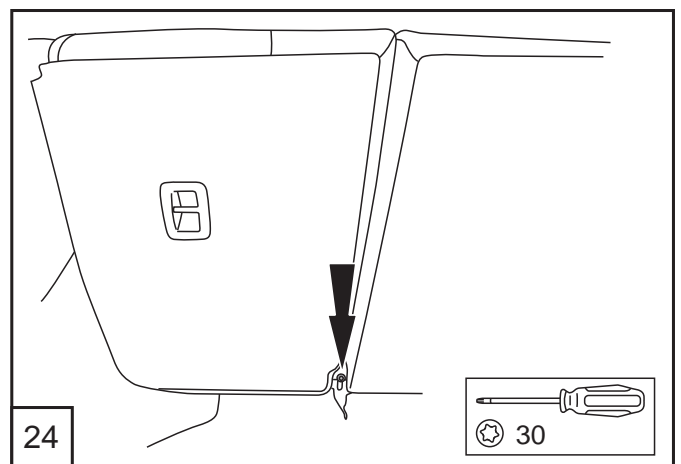
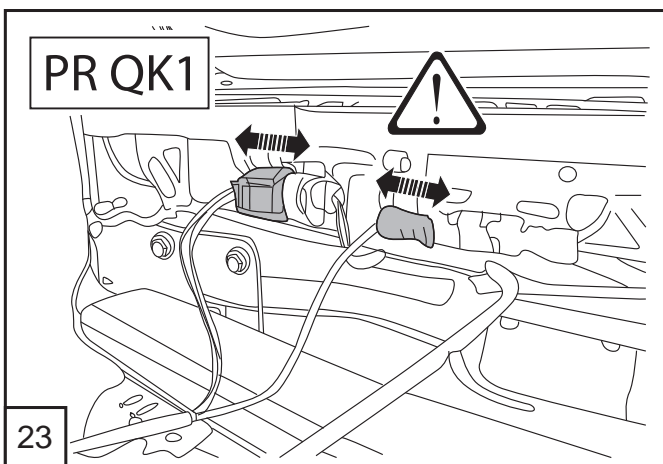
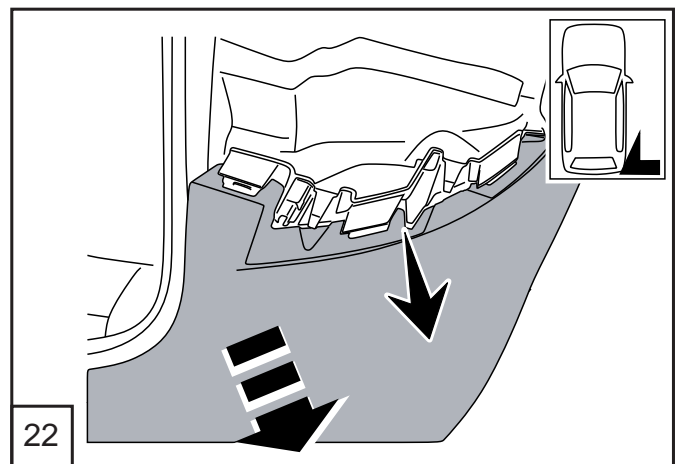
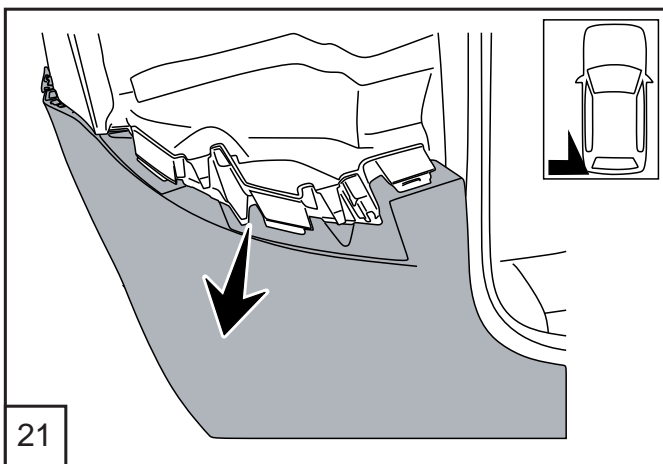
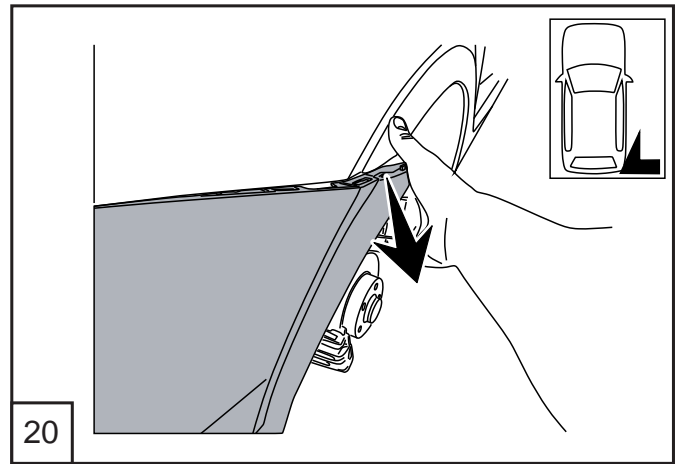
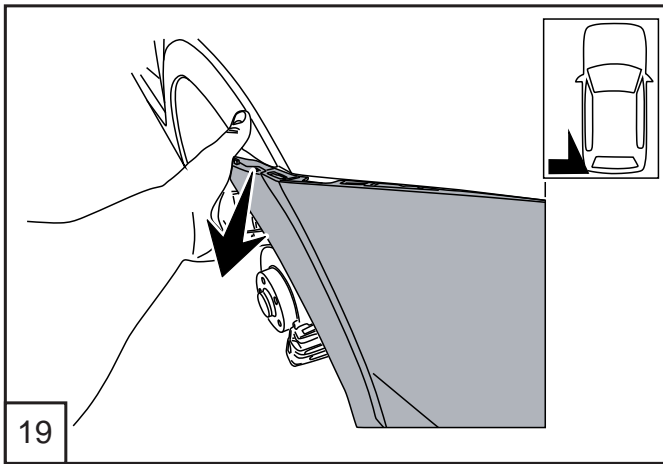
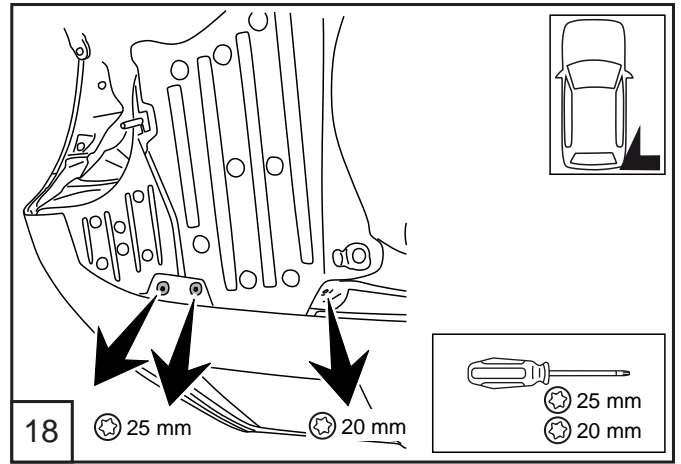
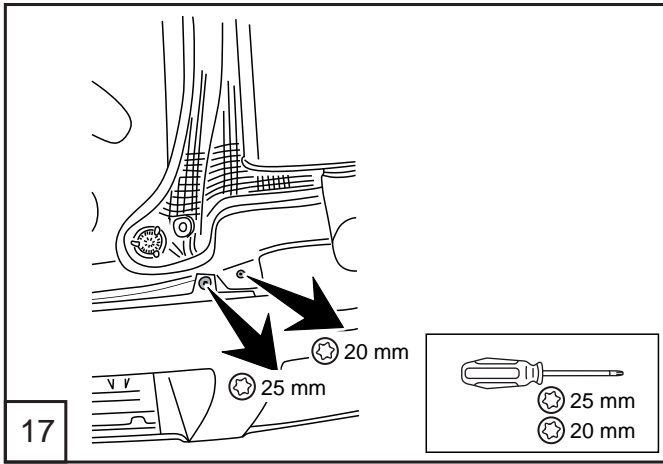

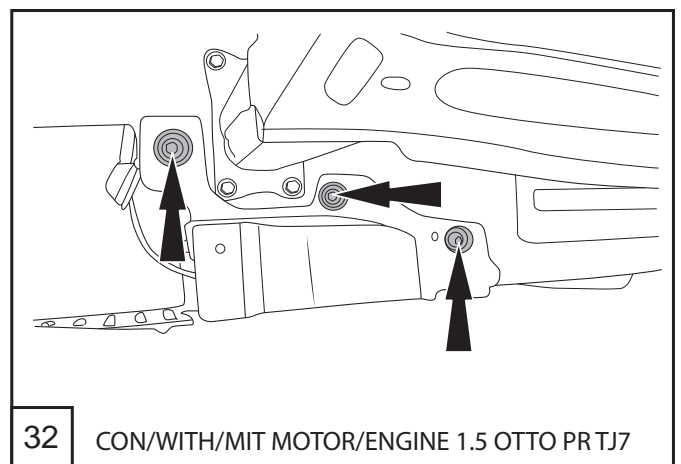
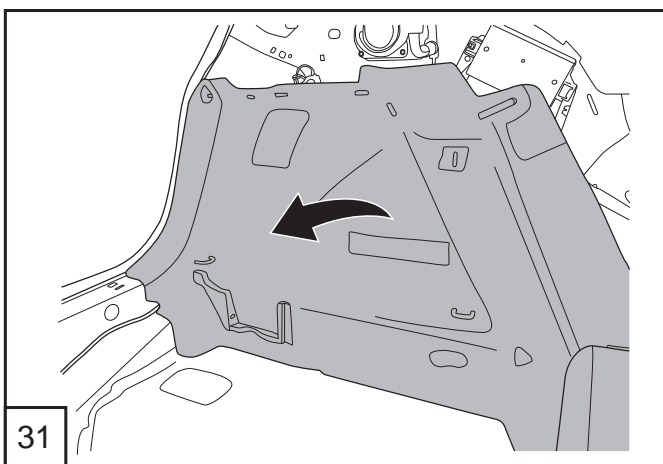
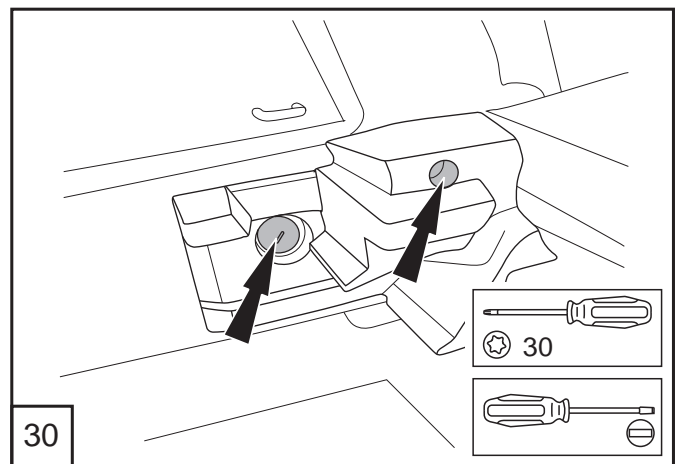
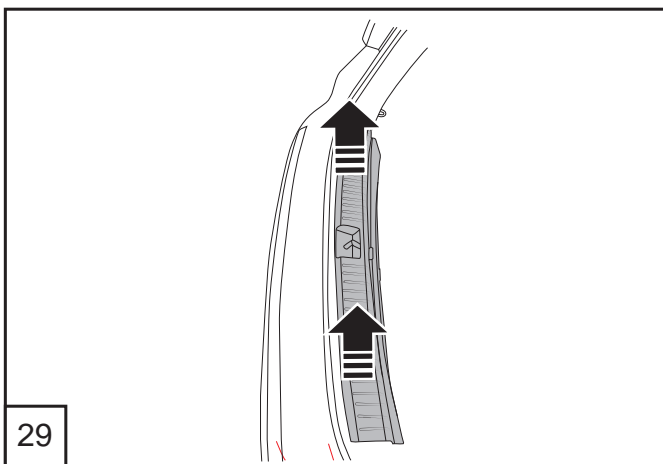
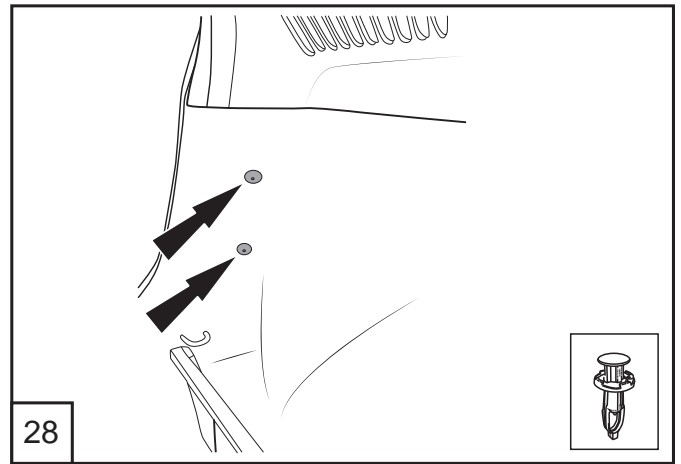
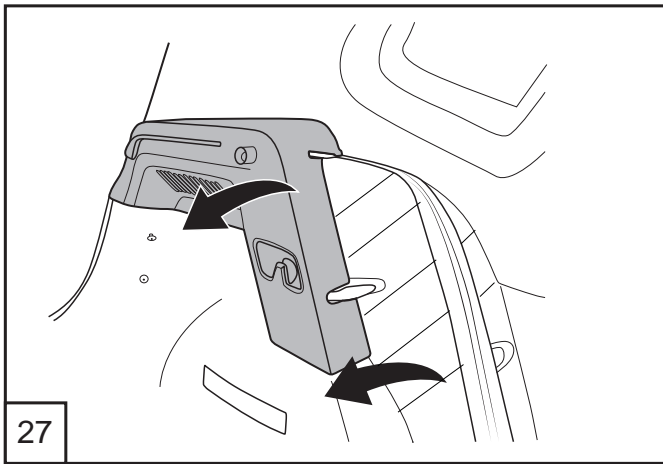
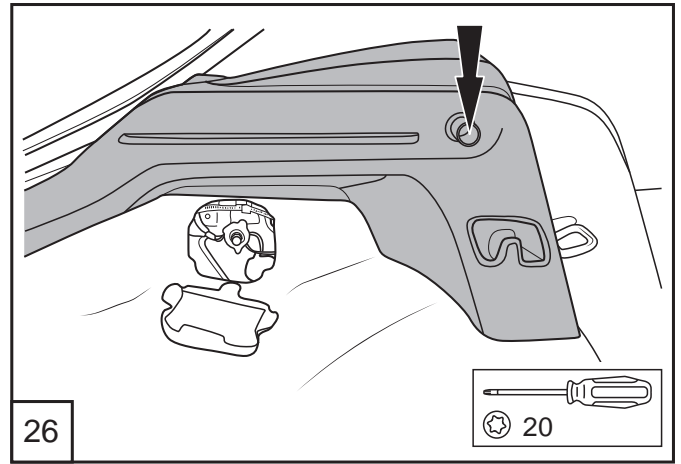
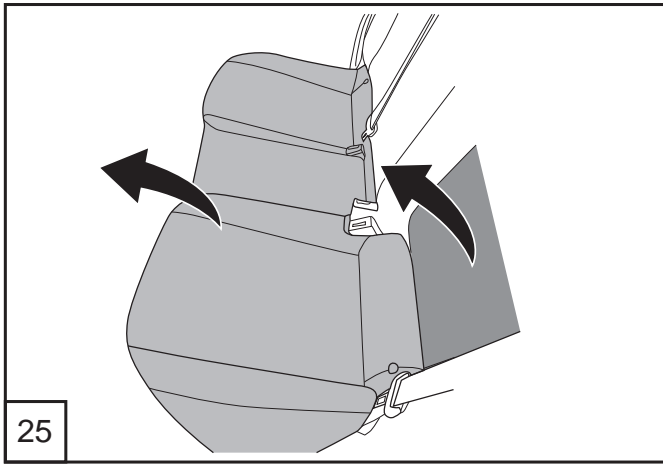

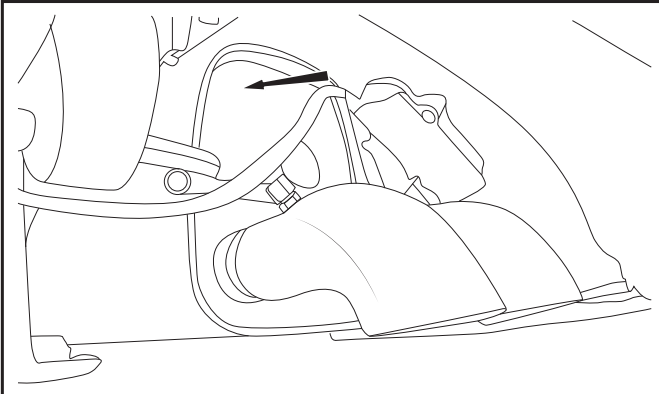

33 CON/WITH/MIT MOTOR/ENGINE 1.5 OTTO PR TJ7

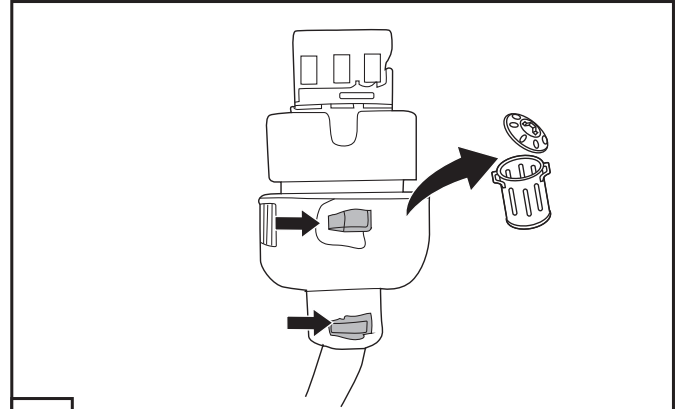

34 CON/WITH/MIT MOTOR/ENGINE 1.5 OTTO PR TJ7

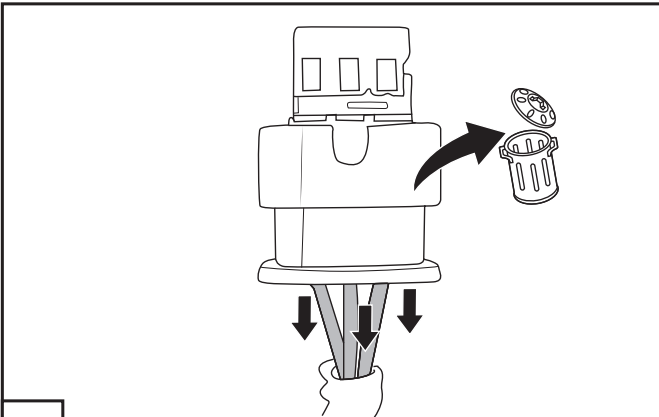

35 CON/WITH/MIT MOTOR/ENGINE 1.5 OTTO PR TJ7

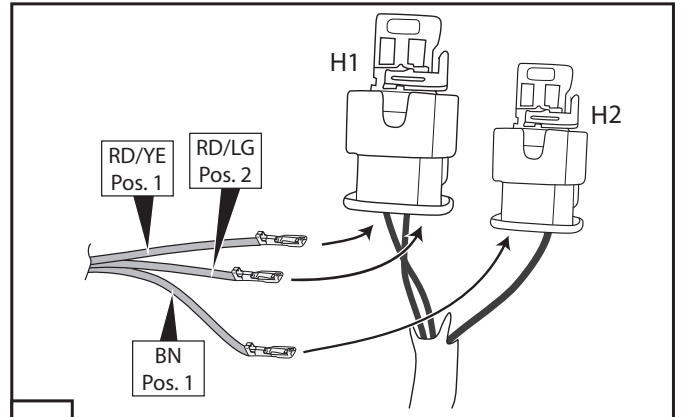

36 CON/WITH/MIT MOTOR/ENGINE 1.5 OTTO PR TJ7

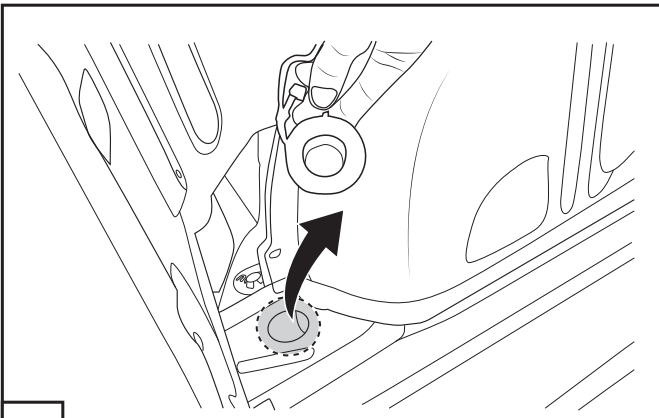

37 LADO IZQUIERDO/LEFT SIDE/LINKE SEITE

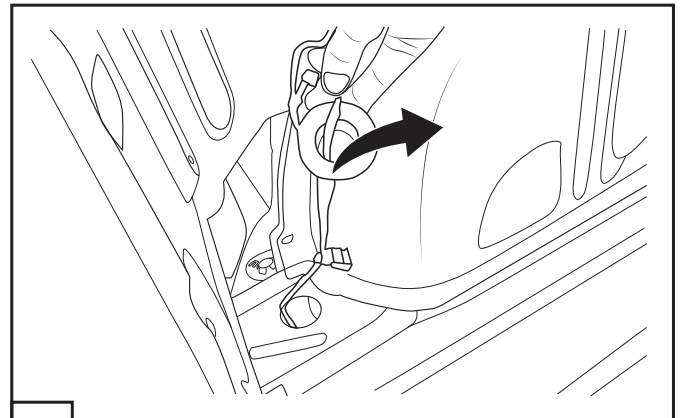

38 CON/WITH/MIT MOTOR/ENGINE 1.5 OTTO PR TJ7

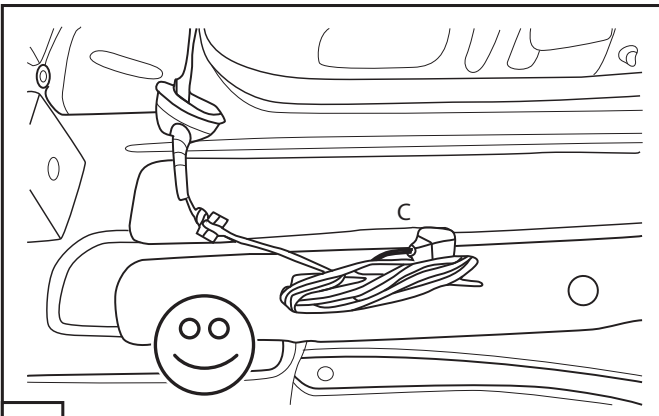

39 CON/WITH/MIT MOTOR/ENGINE 1.5 OTTO PR TJ7

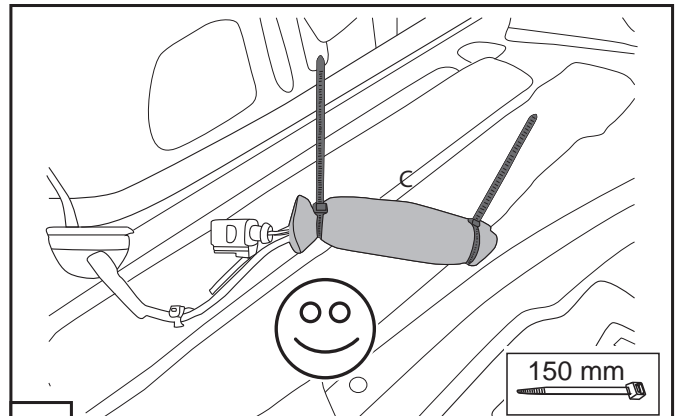

40 CON/WITH/MIT MOTOR/ENGINE 1.5 OTTO PR TJ7

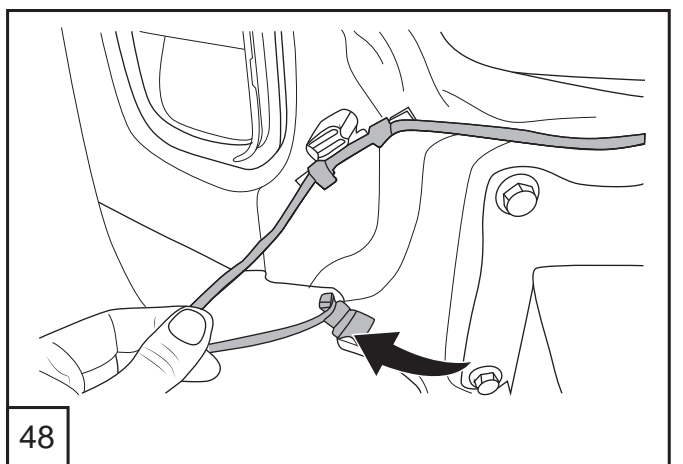
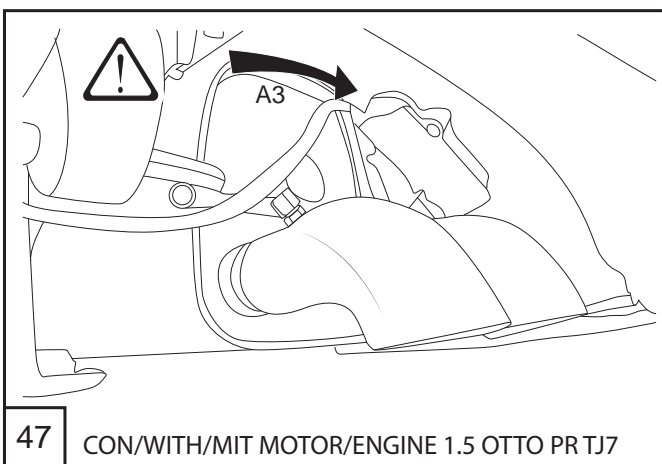
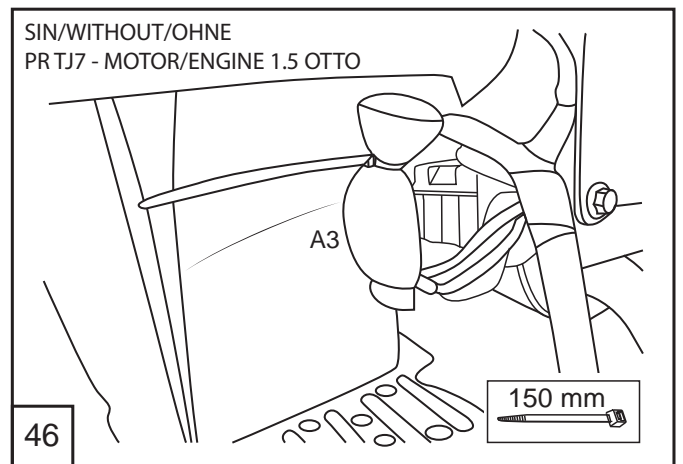
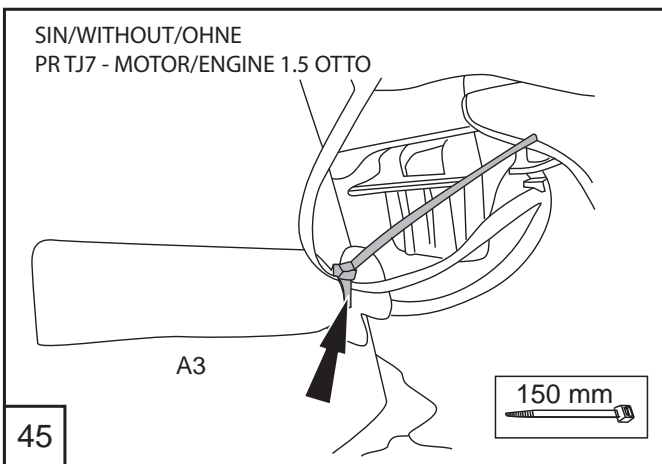
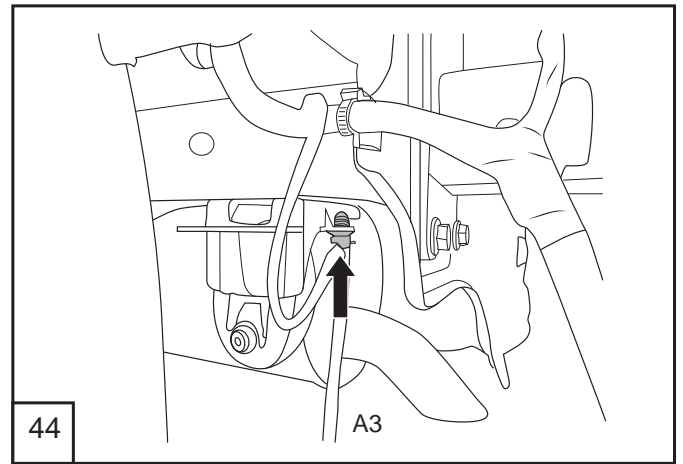
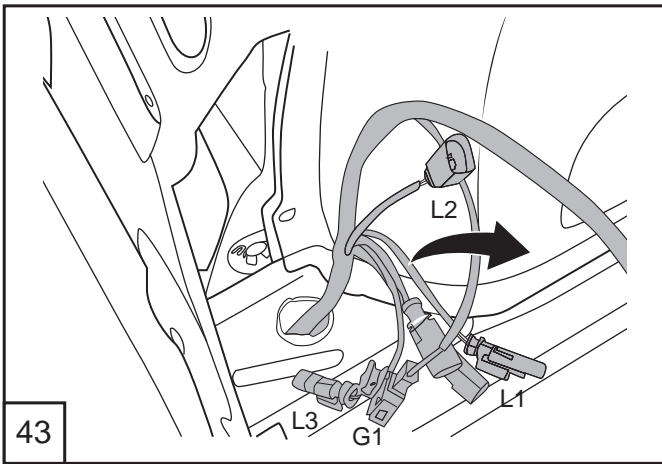
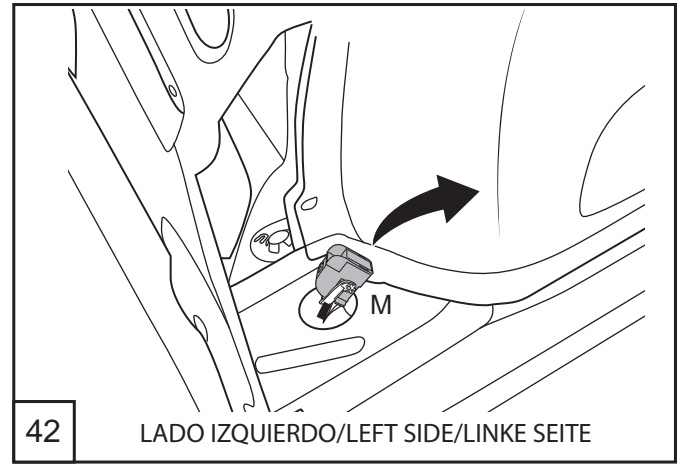
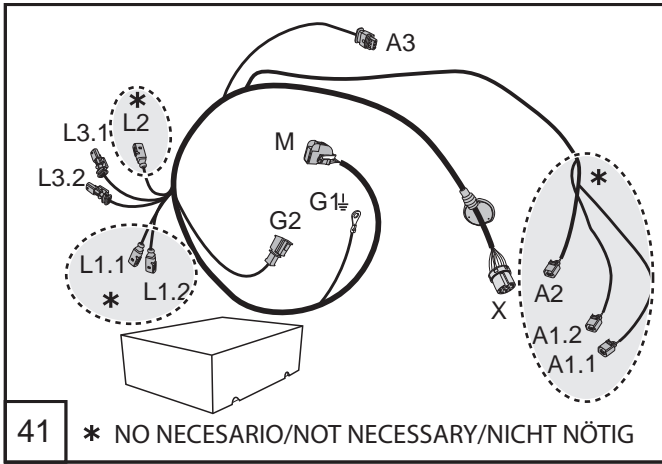

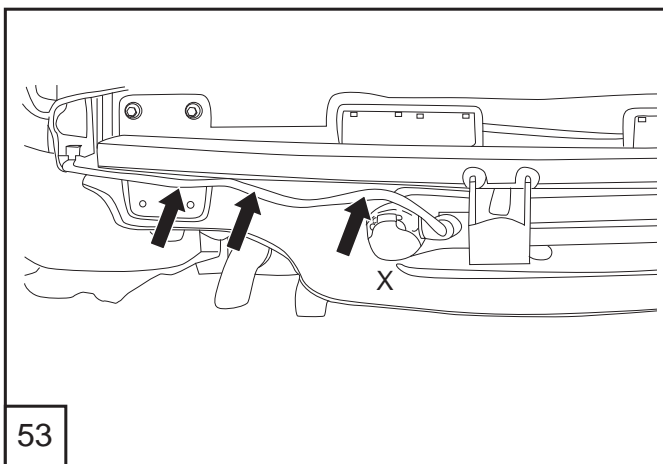
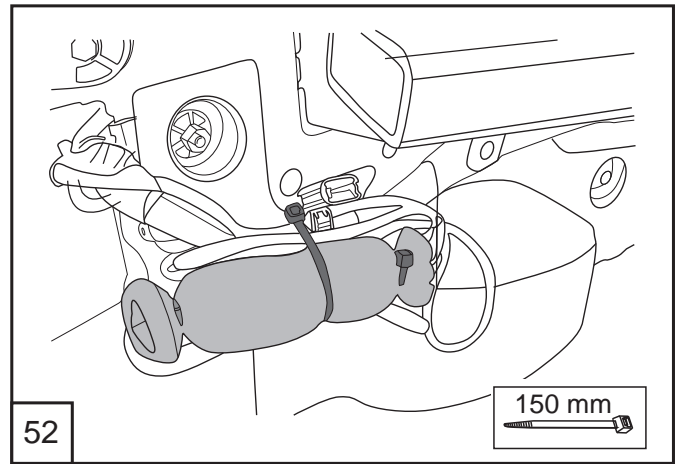
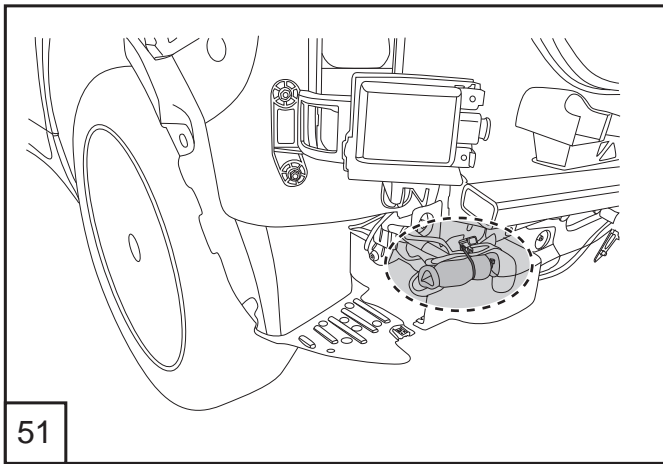
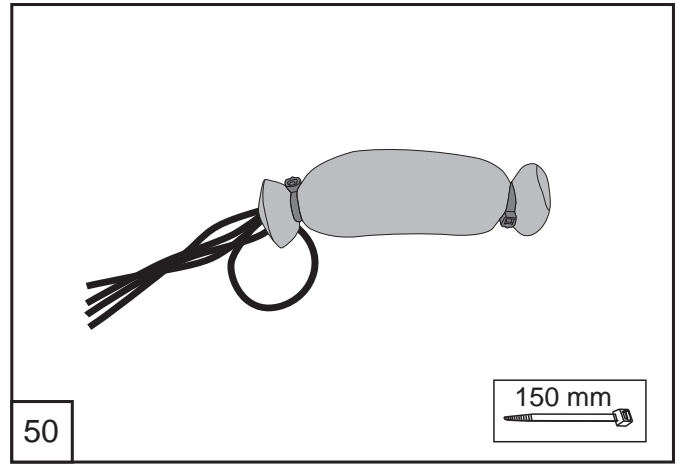
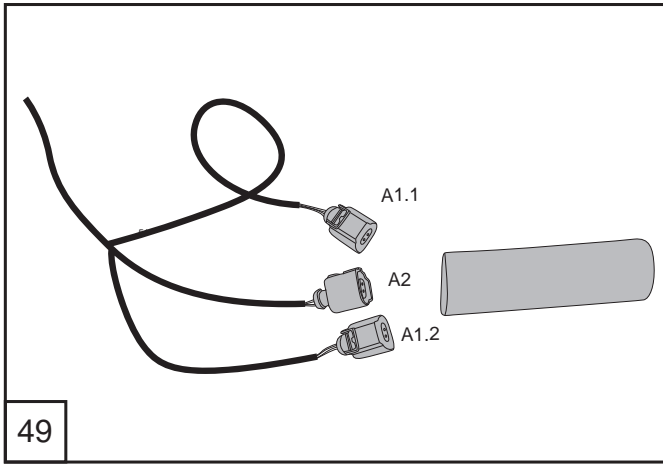

54

- (ES) Conexión de la caja de enchufe
- (DE) Anschluss Steckdose
- (GB) Socket connection
- (IT) Allaccio zoccolo
- (FR) Connection de la prise
- (RU) 6 UKQR e ^LTOL WUNLYQO
- (GR) ΌίίáιòÛ óúέάάδäĩ
- (PT) Conexão da tomada
- (NL) Contactdoos aansluiting
- (CZ) 2EMÞPNRYÍ NRQHNWRU
- (PL) 3R2öF]HQLH SU]H] JQLD]GR
- (CN) *X%-*+ °

 Pag. 20

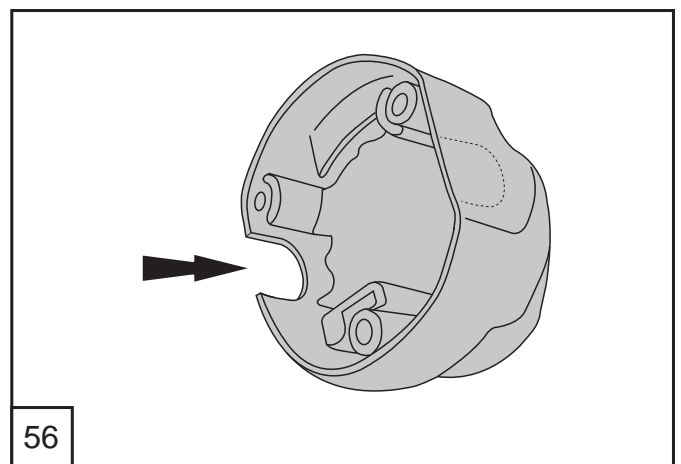
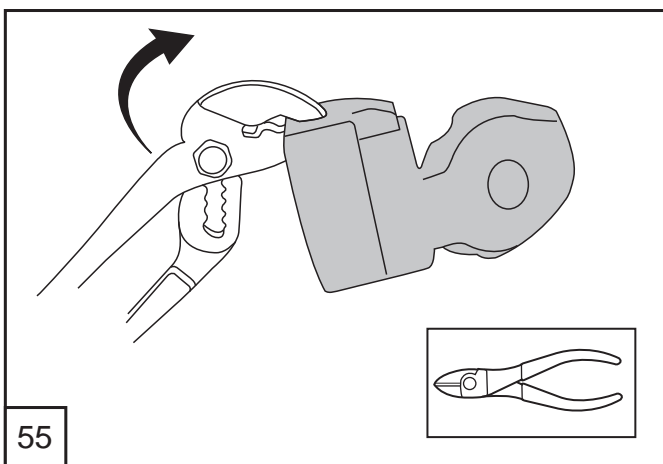

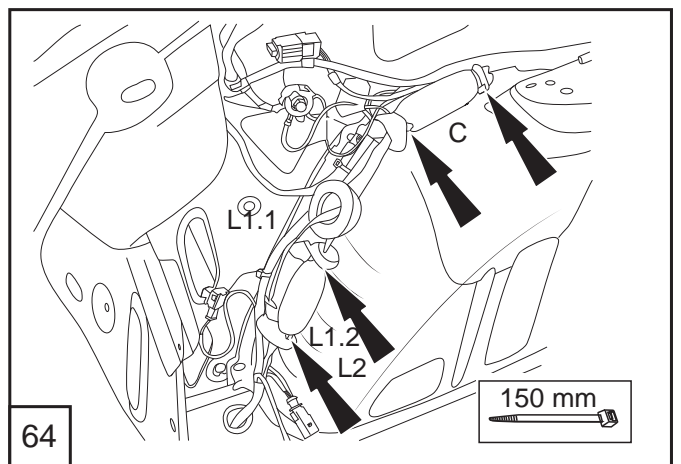
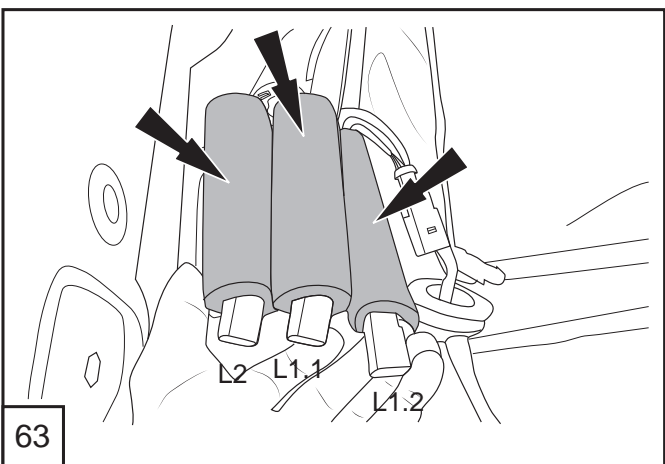
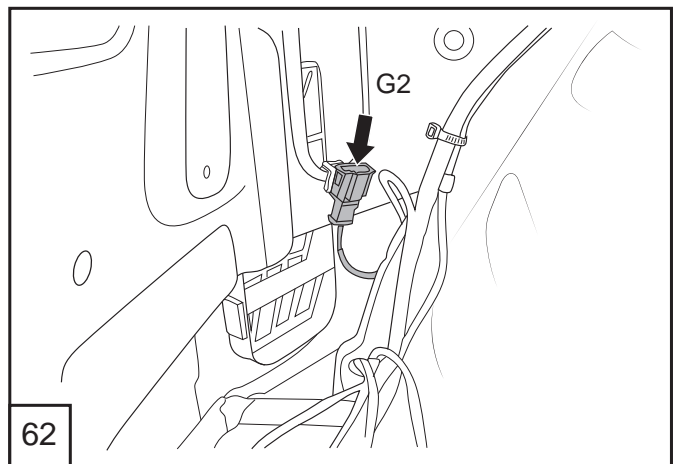
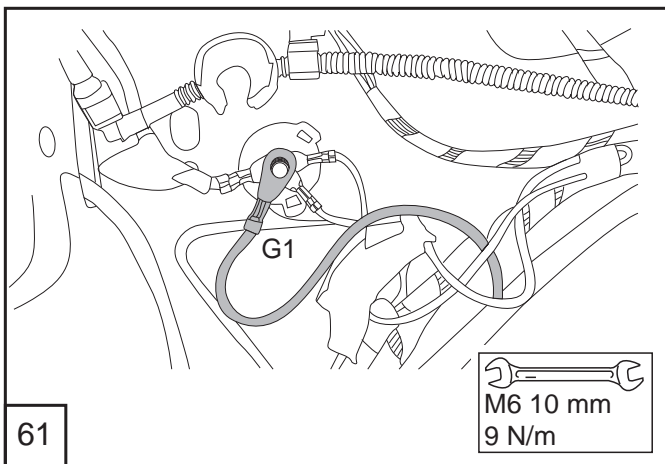
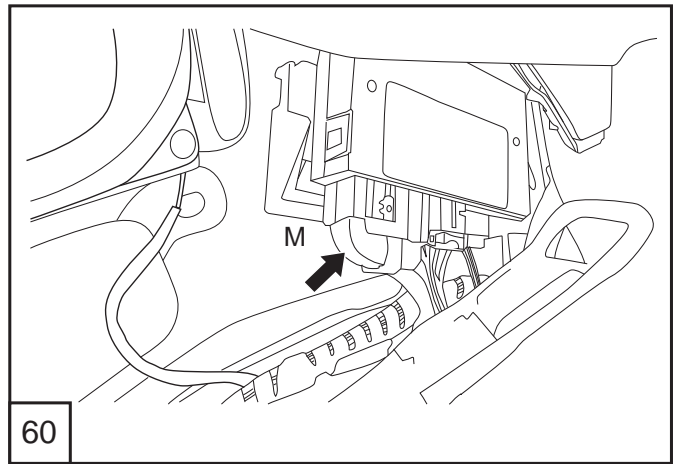
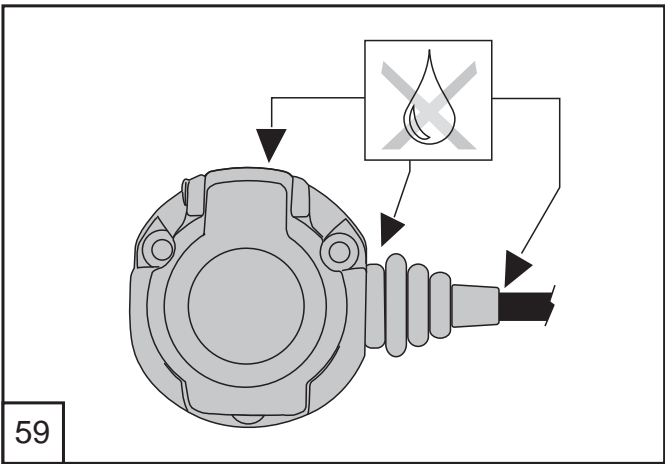
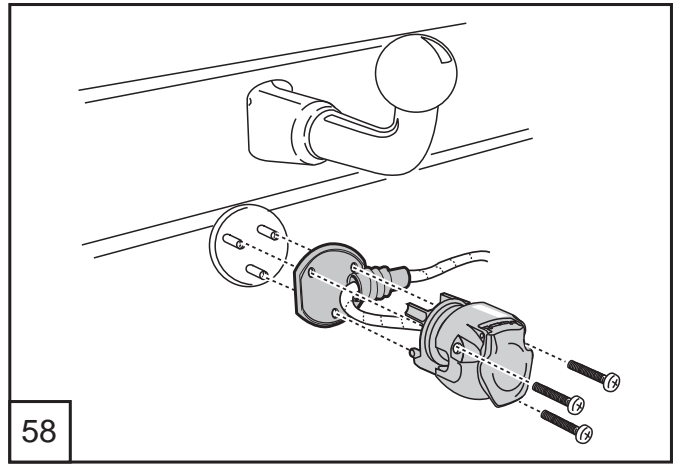
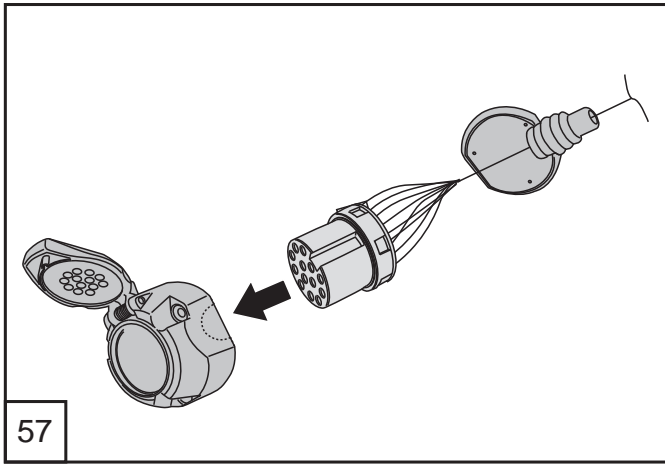

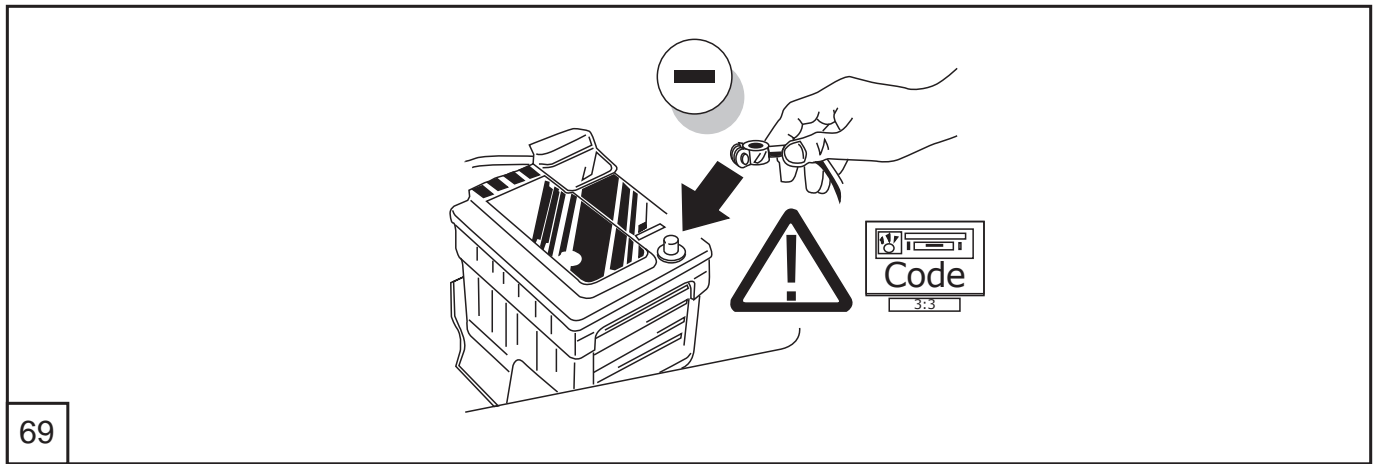
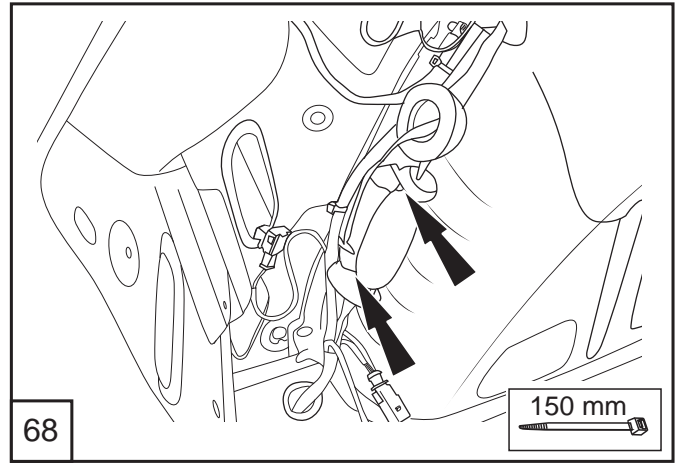
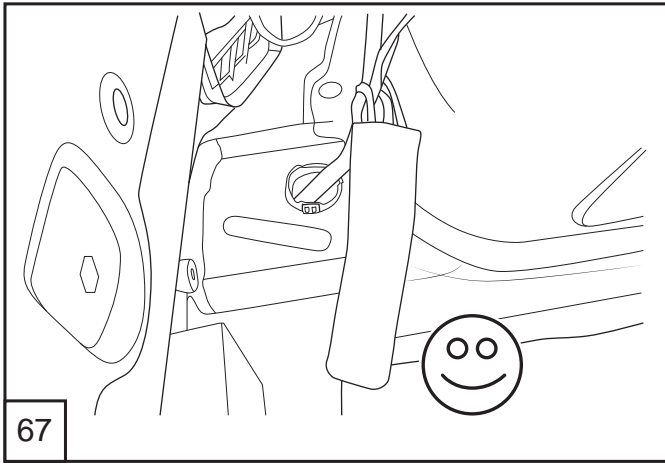
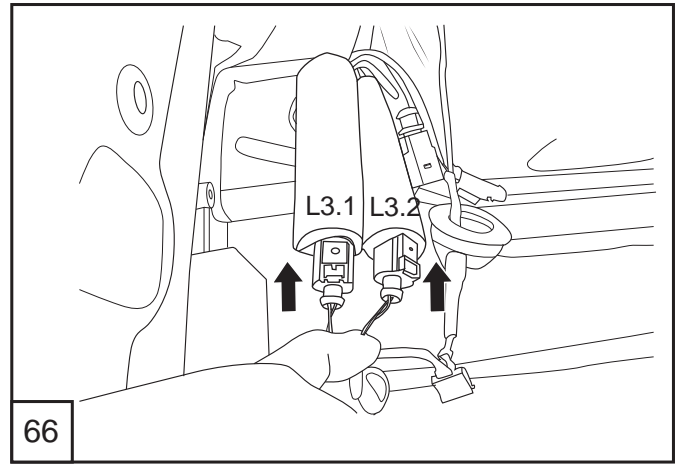
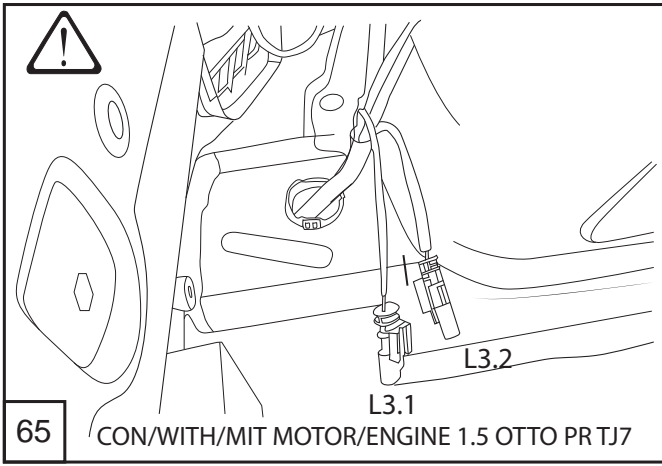

- (ES)** - Conectar el equipo de diagnóstico de vehículo en el enchufe de diagnóstico del vehículo.
 , QLFLDU GLDJQRVLV LGHQWLILFDQGR FRUUHFWDPHQWH HO YHKPFXO
 Codificar la centralita de Gateway según las siguientes indicaciones:
 - Seleccionar el plan de comprobación o función especial "Adaptar el software"
 - Dentro del plan de comprobación o función especial elegir la opción 2 "Realizar)
 reequipamiento"
 - Usar el código SVM KJ695
 - Seguir las instrucciones indicadas en la pantalla del equipo de diagnóstico del vehículo.
 - Interrumpir la conexión del equipo de diagnóstico del vehículo.
- (DE)** - Schließen Sie die Fahrzeug-Diagnoseausrüstung an die Auto-Diagnosesteckdose an.
 6WDUWHQ 6LH GLH 'LDJQRVH PLW GHU \$QJDEH GHV \$XWRV
 - Den Gateway folgendermaßen updaten:
 - Wählen Sie den Prüfplan oder spezielle Funktion "Software anpassen"
 - Innerhalb des Prüfplans oder der speziellen Funktion wählen Sie die Option 2 "Um-
 /Nachrüstlösung"
 - Geben Sie den SVM-Code KJ695
)ROJHQ 6LH GHQ \$QZHLVXQJHQ DXI GHP %LOGVFKLUP GHU)DKUJ
 - Trennen Sie die Fahrzeug-Diagnoseausrüstung ab.
- (GB)** - Connect the vehicle diagnostic equipment to the car's diagnostic socket.
 6WDUW GLDJQRVLV E\ FRUUHFWO\ LGHQWLI\LQJ WKH FDU
 - Update the Gateway according to following steps:
 - Select the checking plan or special function "Adapting software"
 - Inside the checking plan or special function choose the option 2 "Run re-
 /retrofit solution"
 - Code 69 - Trailer function
 - Enter the SVM Code KJ695.
 - Follow the instructions on the screen of the vehicle diagnostic equipment.
 - Disconnect the vehicle diagnostic equipment.
- (IT)** - Collegare la strumentazione diagnostica del veicolo alla presa diagnostica dell'auto.
 \$YYLDUH OD GLDJQRVLV LGHQWLILFDQGR FRUUHWWDPHQWH O«DXWR
 - Aggiornare il Gateway secondo i passaggi seguenti:
 6HOH]LRQDUH ,QWHUIDFFLD GL GLDJQRVWLFDSHU %XV 'DWL
 - Funzione "code bus master" (assemblaggio lista)
 - Codice 69- Funzione trailer
 - Selezionare il pulsante "Funzioni speciali".
 6FHJOLHUH O«RS]LRQH 690 ¥ \$FFHVVRHW WWDWW R«DRCWRFH 690 SHU UH
 - Inserire il codice SVM KJ695
 - Attenersi alle istruzioni sullo schermo della strumentazione diagnostica del veicolo.
 - Scollegare la strumentazione diagnostica del veicolo.
- (FR)** - Connecter l'équipement de diagnostic du véhicule à la prise de diagnostic de la voiture.
 /DQFHU OH GLDJQRVWLF HQ LGHQWLILDQW FRUUHFWHPHQW OD YRLWXUH
 - Actualisez le point d'entrée en suivant ces étapes :
 - Sélectionnez 19 - Interface de diagnostic pour bus de données
 - Fonction "code bus master" (liste d'assemblage)
 - Code 69 - Fonction remorque
 - Sélectionner la touche « Special functions » (Fonctions spéciales).
 &KRLVLU O RSWLRQ œ 690 'LUHFW DFFHWHVFD 690 &RGH \$FBUHVHWLQ
 direct : Code SVM de réinitialisation de la voiture).
 - Saisir le code SVM KJ695
 - Suivre les instructions à l'écran de l'équipement de diagnostic du véhicule.
 - Déconnecter l'équipement de diagnostic du véhicule.
- (RU)** 6UKQR e^OYL KOGJTUXYO^LXQOP VWOHUWQYKUSGHTURX YYO^LXQUSZ WGI
 4G^TOYL KOGJTUXYOQZ X VWGIORcTUJU UVWLKRLTof GIYUSUHORf
 5HTUIOYL _ReN VWLKVWOTOSGf XRLKZe`OL _GJO
)bHLWOYL KOGJTUXYO^LXQOP OTYLW[LPX KRf _OTb KGTTb\
 ;ZTQ]Of QUK SGXYLWG _OT VUXRLKUIGYLRcTUXYc XHUWQO
 1UK [ZTQ]Of 9WLPRLW
 4GMSOYL QTUVQZ 6SHFLDO IXQFWLRQV 8VL]OGRcTbL [ZTQ]OO
)bHLWOYL IGWOGTY 690 'LUHFW DFFHWHVFD 690 &RGH IRU UHVHWLQ
 690 ¥ 6WfSUP KUXYZV QUK 690 KRf VLWLZXYGTUIQO GIYUSUHORf
)ILKOYL 690 QUK .-
 8RLKZPYL ZQGNTOfs KOGJTUXYO^LXQUJL QWOTLUWG VUfirfe OSXf T
 5YXULKOTOYL KOGJTUXYO^LXQOP VWOHUW GIYUSUHORf

- (ES) ¡Controlar funciones con un tester con carga o luces con el correcto voltaje!
- (DE) Funktionen kontrollieren mit einem prüfgerät mit widerstand oder mit leuchten mit der genauen wattzahl!
- (GB) Test all circuit functions with a testbox with the correct power load for each unit. A testbox on which only leds are used can not be used in this case.
- (IT) Controlla funzioni con un tester con carico o lampade del giusto wattaggio!
- (FR) Contrôler les fonctions avec une boîte de test avec de la charge ou des lampes avec la quantité correcte de watt!

(RU) VWUILWcYL WGHUYZ IXL\]LVLP X VUSU`ce YIWXZNLQMGKRW @ G/MIGU OIR dHTRU PQTG I KGGTUS XRZ^GL TLRcNf URcNUIGYcXf YLX XILWYUSK QUXKTS OTTbS YURcQU

(GR) àèääëñá ñæð èääñiòìàæáð éá ÚéP çæß thääiðáððçæñæð íðíðñimæð ðPðPéí

(PT) Verifique o correto funcionamento do kit com a tester com resistência direita ou lâmpadas real!

(NL) Controleer functies met een tester met belasting of lampen met de juiste wattage!

(CZ) 2Y IWH IXQNFH SRPRFÞ WHVWRYDFÞKR YENRQER VY WHO V SILVOXQQÎP

(PL) 6SUDZGj IXQNFMH XI\ZDMöF VNUJ\QNLVGHVWJRHMLJ IDEBZNDIRQL HRPROSER ZIRHGQ

(CN) ;@1é>ðRDEô;»S#ý= 3ÑR[-X-ë3ÑR[2U °OKEô= (Æ-•;»Tu %Gf >V_@S'K ; 'ÆÍ p• O H G 6ö3ÑR[-X,f3[;@



72

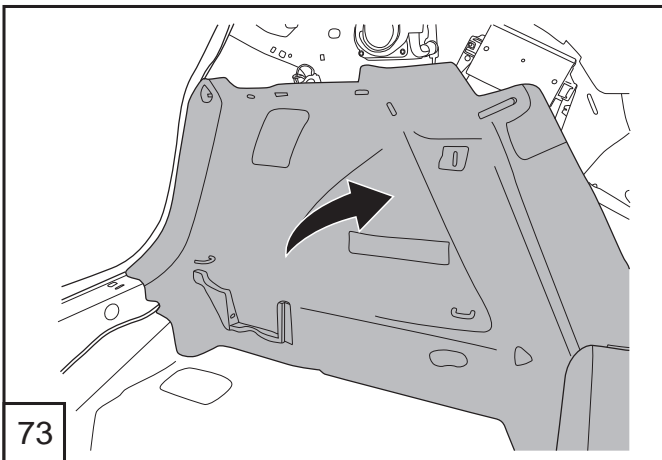

73

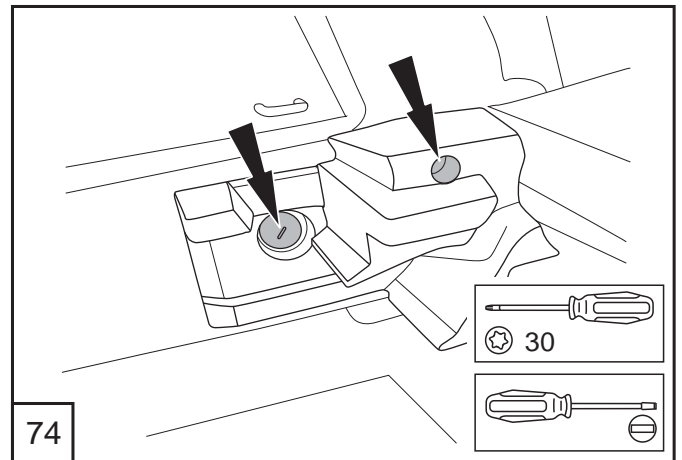

74

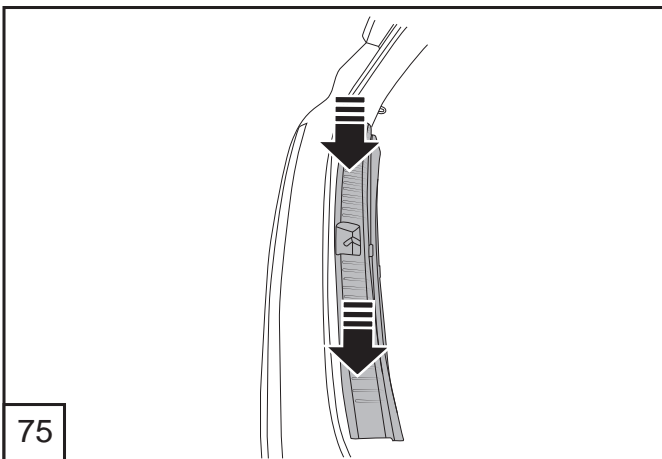

75

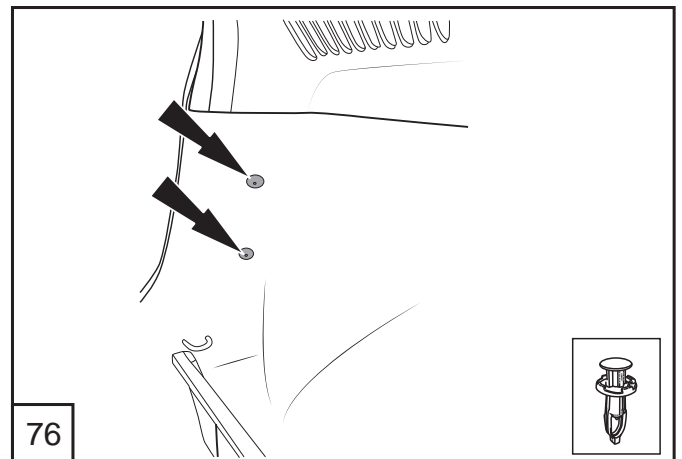

76

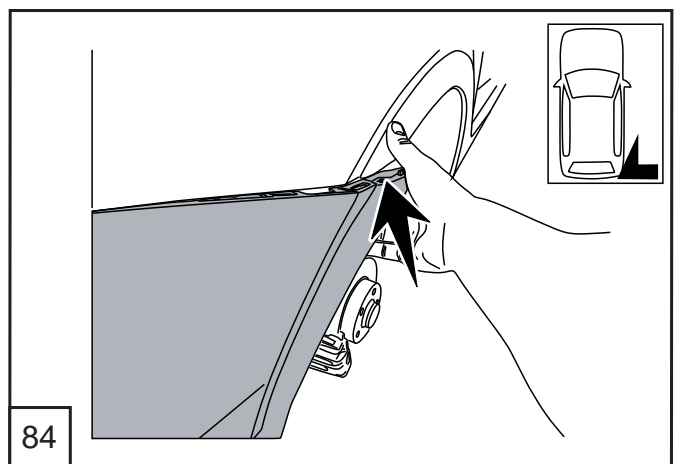
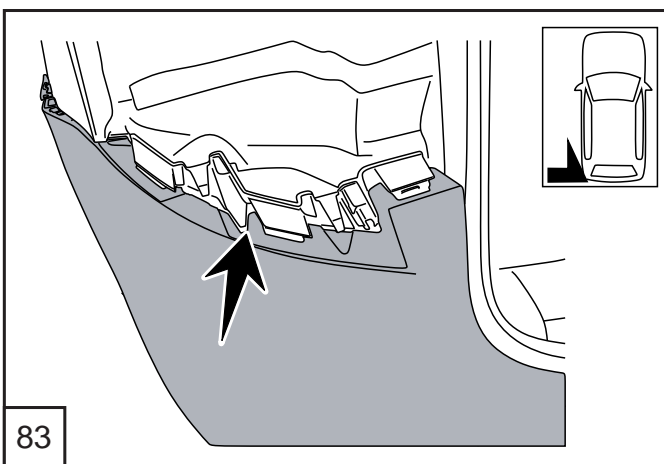
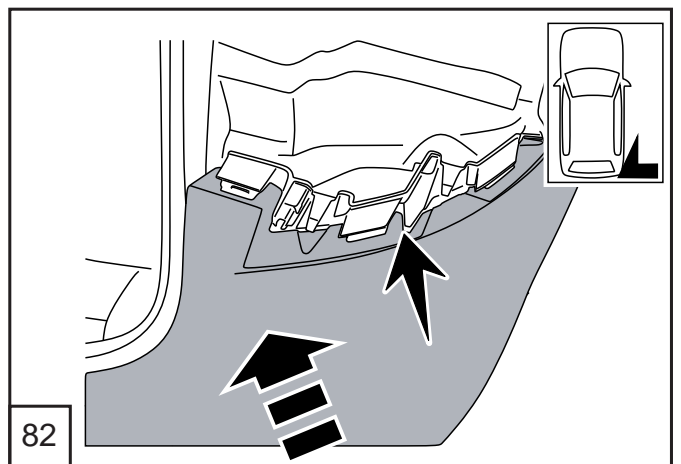
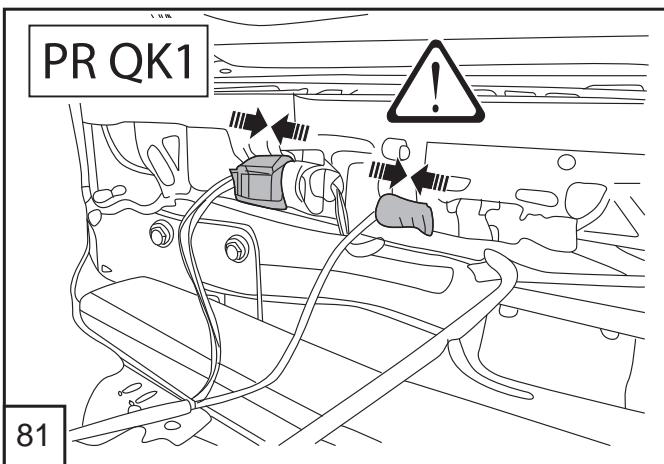
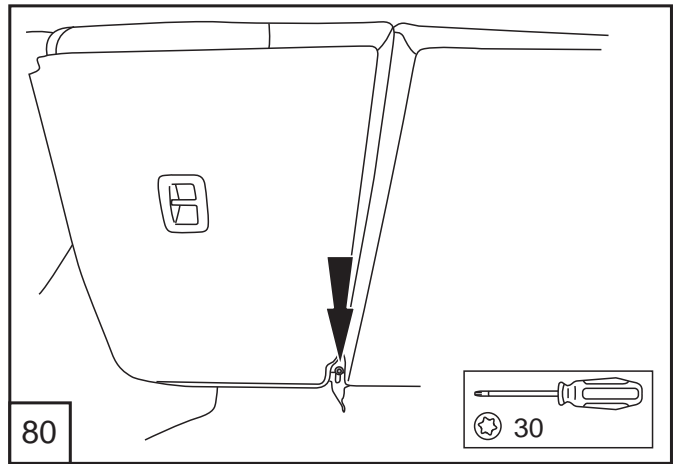
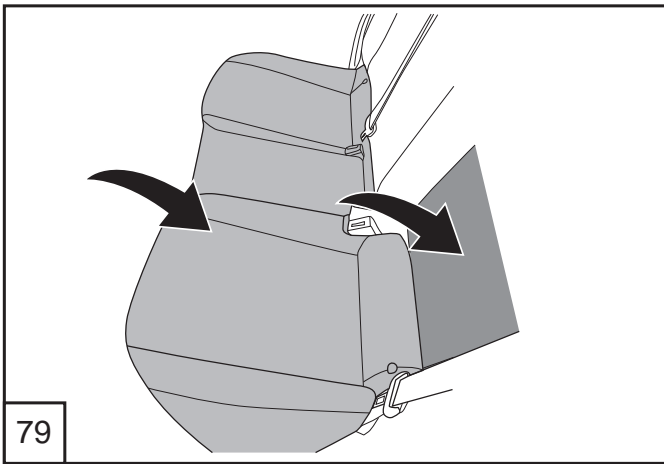
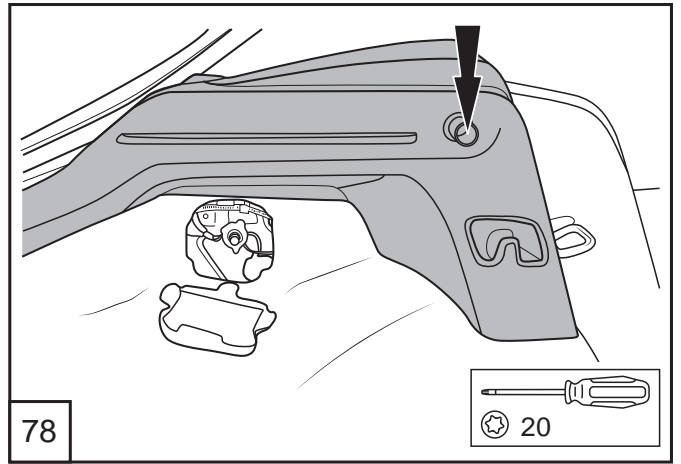
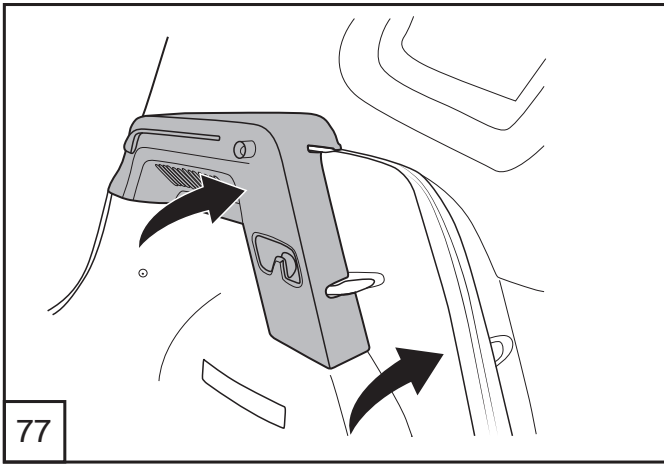

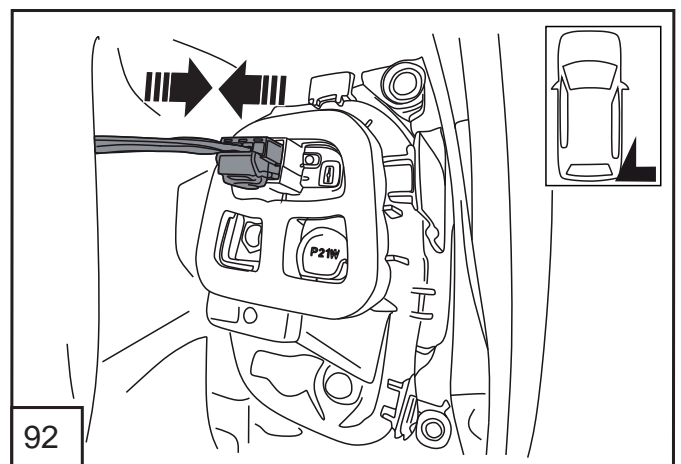
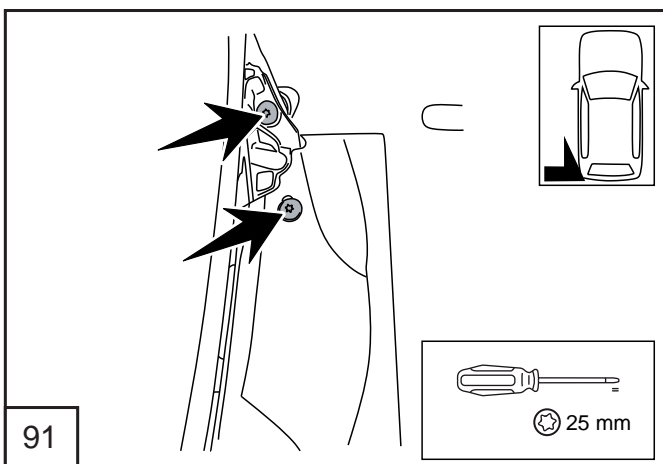
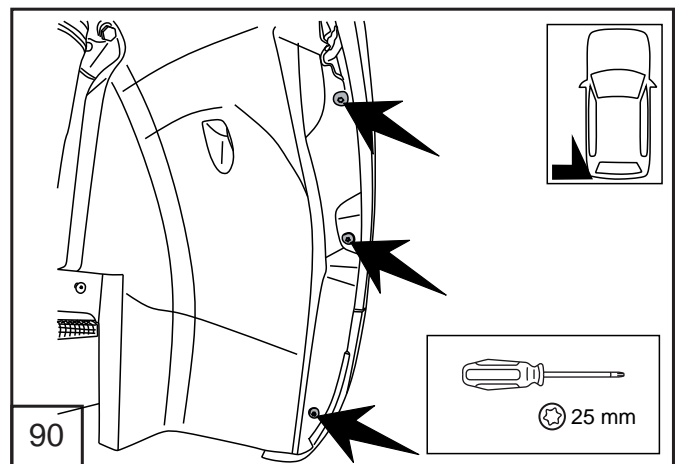
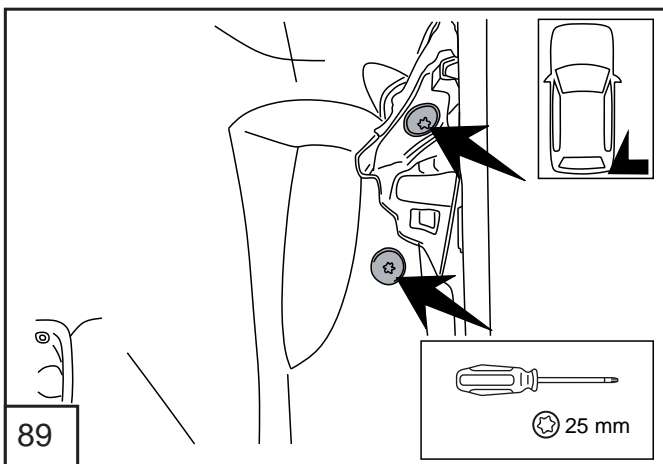
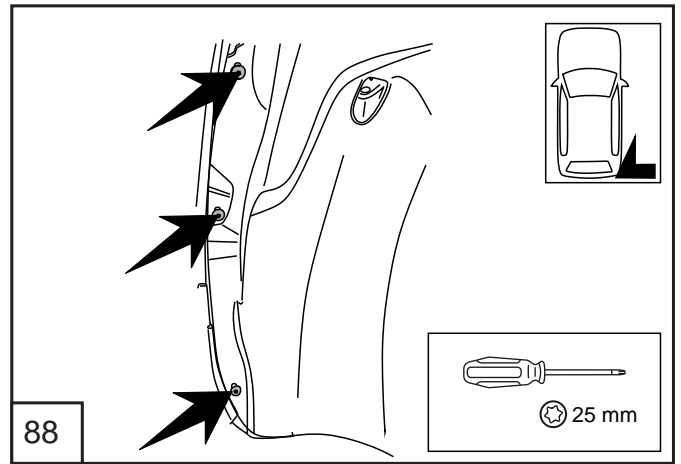
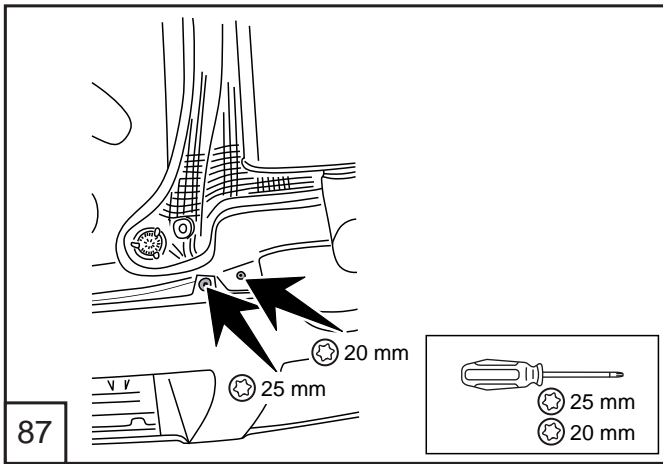
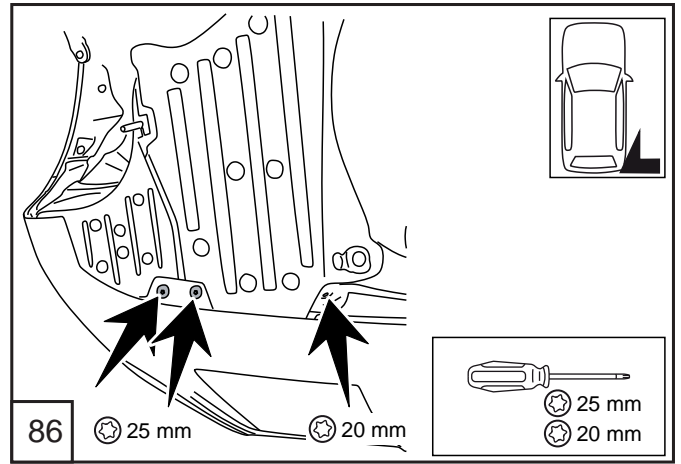
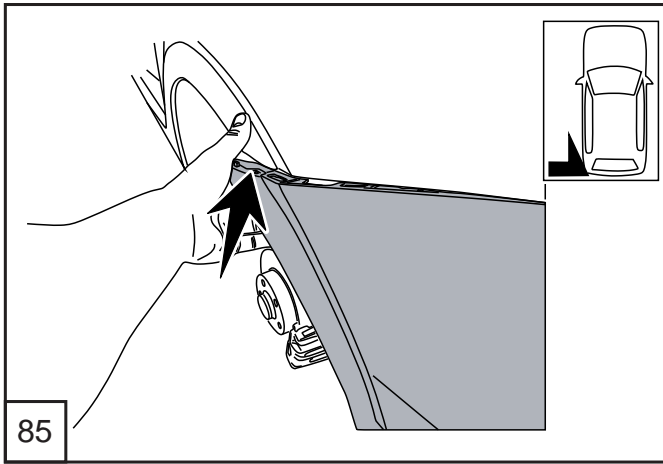

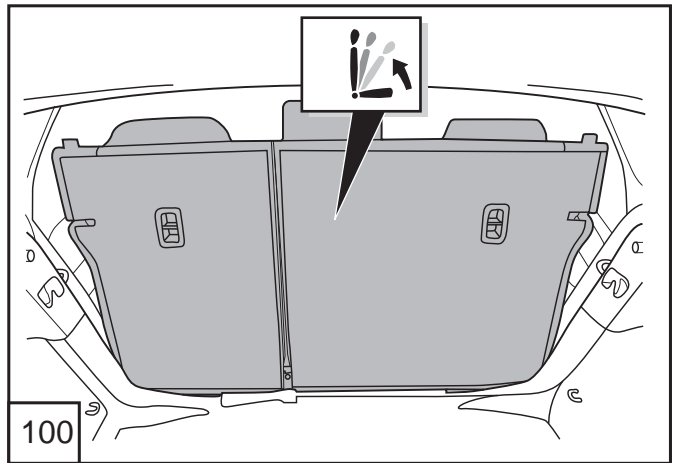
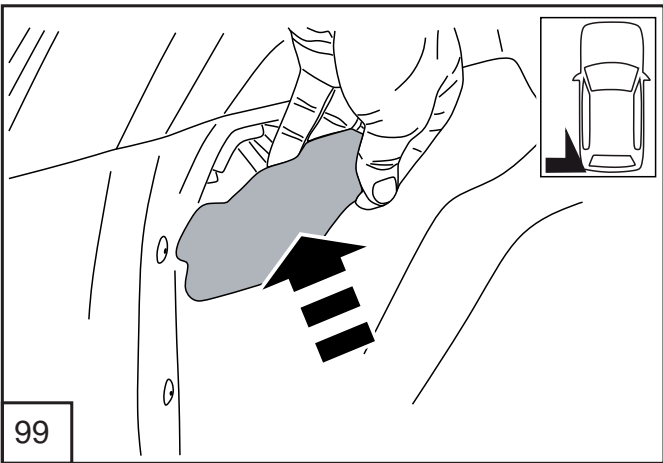
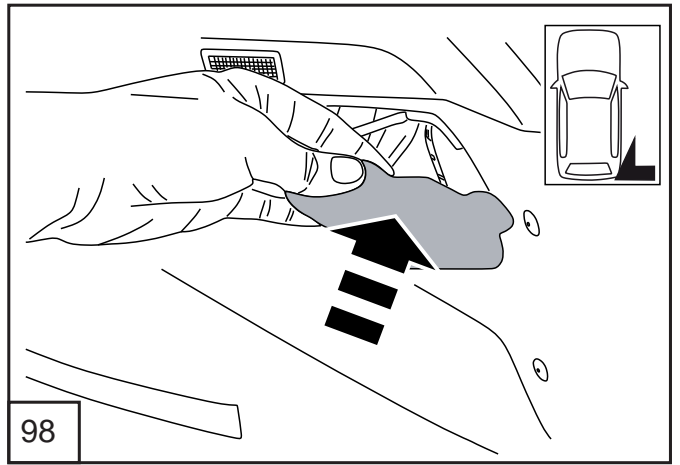
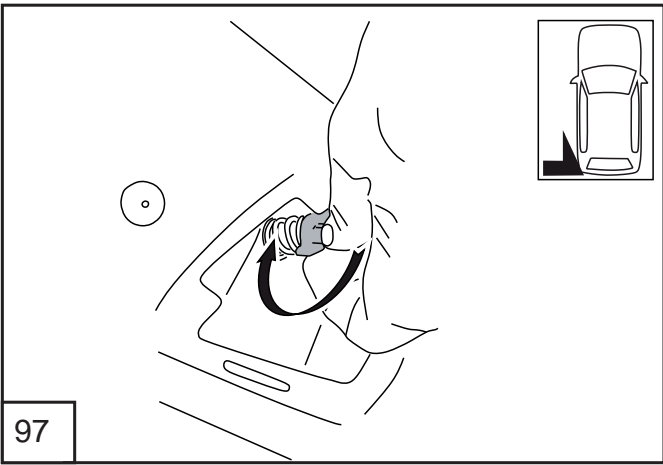
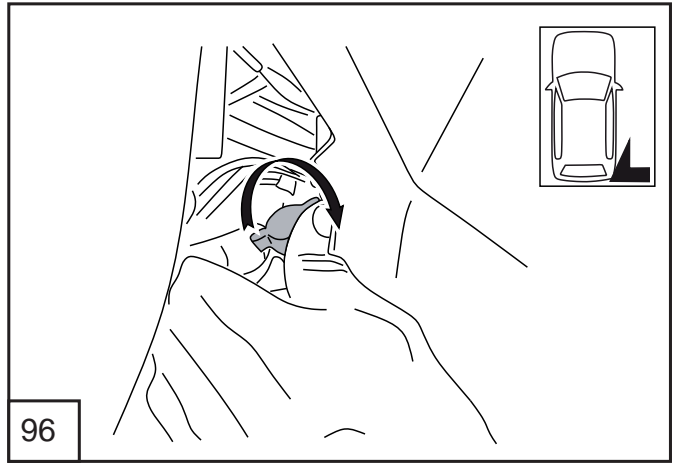
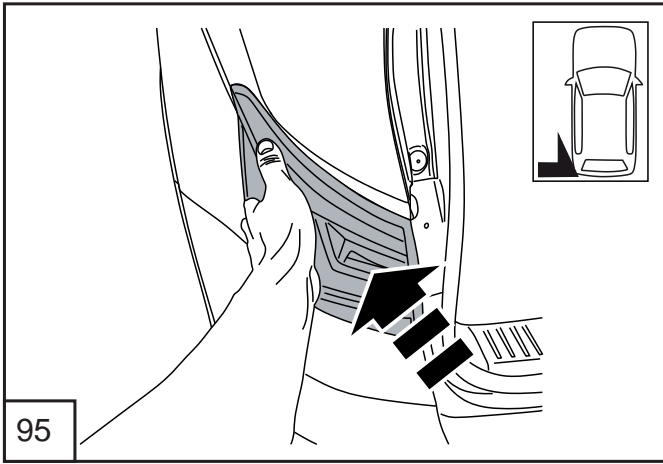
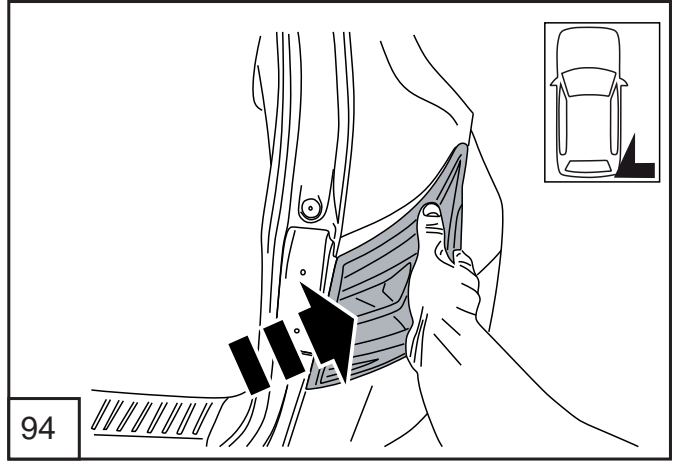
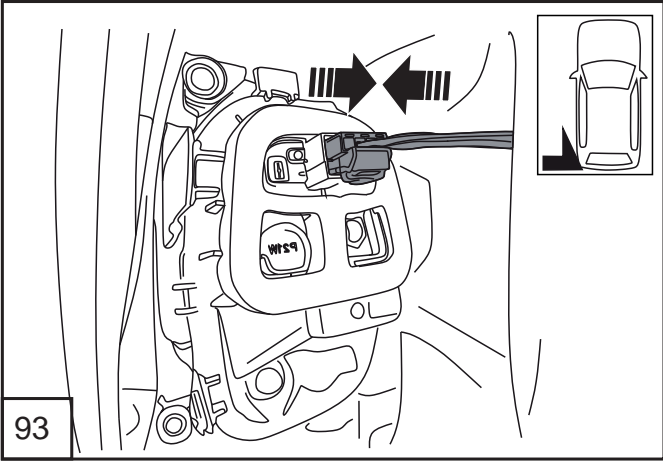

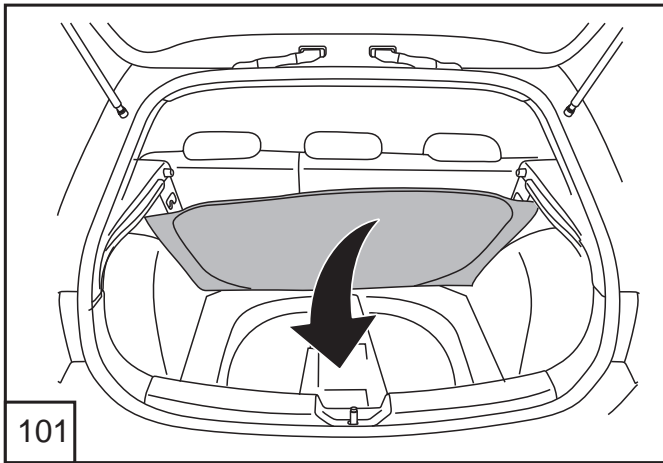

101

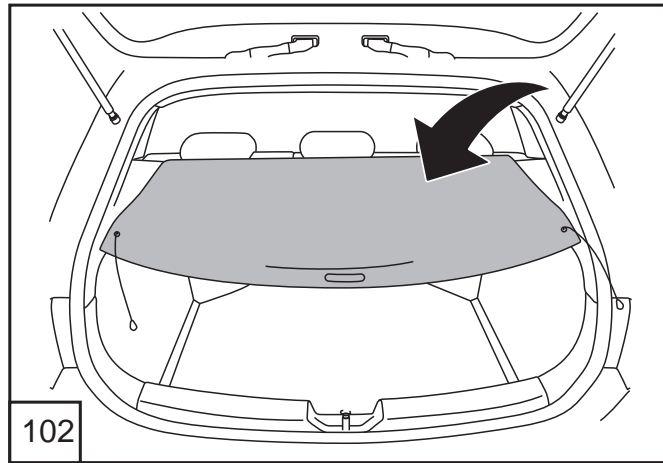

102

Guía del usuario
 Gebrauchsanleitung
 User guide
 Manuale di istruzioni
 Mode d'emploi
 /TXYWZQJOf VU
 OXVURcNUIGTO
 Íáääüí ôîÛðñã
 Guia do usuário
 Gebruikershandleiding
 8nLYDWHOVNÒ SÍPUXpND
 ,QVWUXNFMD REV2XJL
 ;@(!½)•Ý >

103

Conexión de la caja de enchufe
Anschluss Steckdose
Socket connection

Allaccio zoccolo
Connection de la prise

Ό ή ί α ί ο ύ δ ύ έ ά ά δ α ί
Conexão da tomada

2 E M P P N R Y İ N R Q H N W R U
3 R 2 ö F J H Q L H S U J H J Q L D J G R
X%-+°

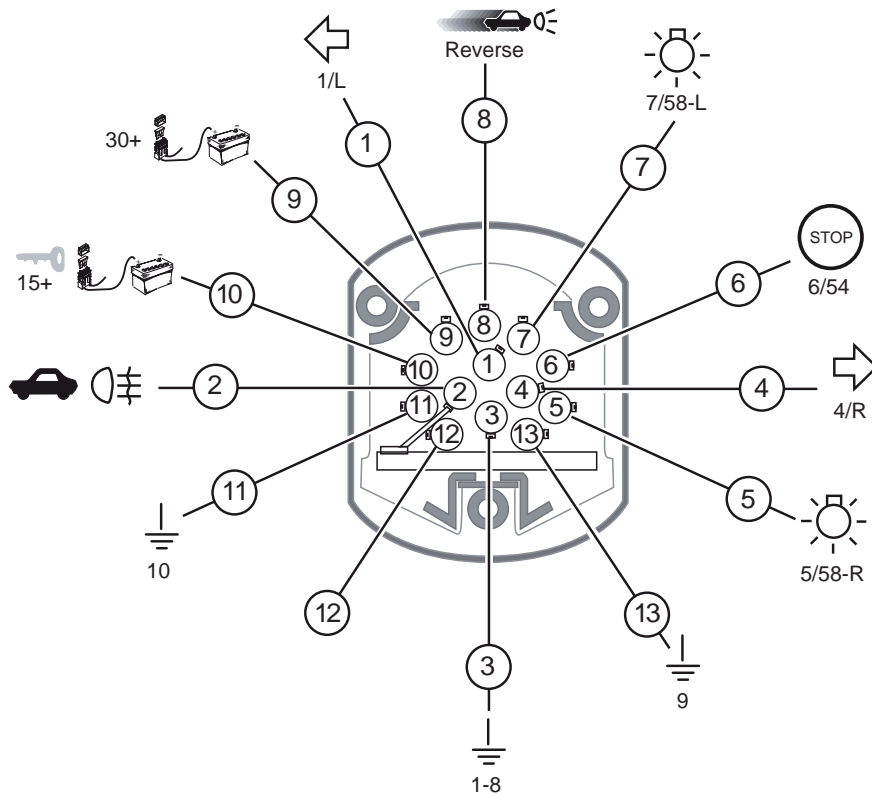

| DIN/ISO 11446 | ← 1/L | ↻ 2 | ⊥ 1-8 3/31 | → 4/R | ☀ 5/58-R | STOP 6/54 | ☀ 7/58-L | Reverse 8 | 30+ 9 | 15+ 10 | ⊥ 10 11 | — 12 | ⊥ 9 13 |
|---------------|-------------------------|-------------|---------------|--------------------------------|----------------------------|----------------------------|--------------------------|-------------|---------------|---------------|---------------|---------|-------------------|
| Pmax | BK/WH | BU | BN | BK/GN | GY/RD | BK/RD | GY/BK | BK | RD | YE | BN | - | BN |
| ES | Negro/ % O D Q F R | Azul | Marrón | Negro/ Verde | Gris/ Rojo | Negro/ Rojo | Gris/ Negro | Negro | Rojo | Amarillo | Marrón | - | Marrón |
| DE | Schwarz/ Weiß | % O D X | % U D X Q | Schwarz/ Grün | Grau/ Rot | Schwarz/ Rot | Grau/ Schwarz | Schwarz | Rot | Gelb | % U D X Q | - | % U D X Q |
| *% | % O D F N White | % O X H | % U R Z Q | % O D F N Green | Grey/ Red | % O D F N Red | Grey/ % O D F N | % O D F N | Red | Yellow | % U R Z Q | - | % U R Z Q |
| IT | Nero/ % L D Q F R | % O X | Marrone | Nero/ Verde | Grigio/ Rosso | Nero/ Rosso | Grigio/ Nero | Nero | Rosso | Giallo | Marrone | - | Marrone |
| FR | Noir/ % O D Q F | % O X H | Marron | Noir/ Vert | Gris/ Rouge | Noir/ Rouge | Gris/ Noir | Noir | Rouge | Jaune | Marron | - | Marron |
| RU | > L W T b P (L R b P | 8 O T O P 1 | U W O A T 1 | L b P W T b P . L R L T b P | 8 L W b P 1 W G X T b P | > L W T b P 8 L W b P | 8 L W b P P L W T b P | > L W T b P | 1 W G X T b P | P L R Y b P | 1 U W O A T 1 | L i b P | 1 U W O A T 1 b P |
| GR | Έ β ú ï ï É á ó ç ù | Έ ï è á | Έ β ó Ú | Έ β ú ï ï ï ï ù ð æ è ï | Ά ç ï æ È ù ç ç æ è ï | Έ β ú ï ï È ù ç ç æ è ï | Ά ç ï æ È β ú ï ï | Έ β ú ï ï | È ù ç ç æ è ï | È Û ñ ï æ è ï | Έ β ó Ú | - | Έ β ó Ú |
| PT | Preto/ % U D Q F R | Azul | Marrom | Preto/ Verde | Cinza/ Vermelho | Preto/ Vermelho | Cinza/ Preto | Preto | Vermelho | Amarelo | Marrom | - | Marrom |
| NL | Zwart/ Wit | % O D X Z | % U X L Q | Zwart/ Groen | Grijs/ Rood | Zwart/ Rood | Grijs/ Zwart | Zwart | Rood | Geel | % U X L Q | - | % U X L Q |
| CZ | ý H U Q Ó % β O Ó | Modrá | + Q G Ó | ý H U Q Ó Zelená | Šedá/ ý H U Y H Q | ý H U Q Ó Q Ó H U Y H Q | Šedá/ Ó ý H U Q Ó | ý H U Q Ó | ý H U Y H Q | Q Ó M O X W Ó | + Q G Ó | - | + Q G Ó |
| PL | Czarna/ % L D 2 D | Niebieska | % U ó] R Z D | Czarna/ Zielona | Szara/ Czerwona | Czarna/ Czerwona | Szara/ Czarna | Czarna | Czerwona | k á 2 W Ó | % U ó] R Z D | - | % U ó] R Z D |
| CN | eWHø = Hø | KcHø | /[Hø | eWHø E...Hø | 6øHø E(Hø | eWHø E(Hø | 6øHø eWHø | eWHø | E(Hø | eJHø | /[Hø | - | /[Hø |

- (ES)** La información sobre los datos técnicos, el diseño, la equipación, los materiales, las garantías y el aspecto externo se refiere al momento en que las instrucciones de montaje se envían a imprimir. El fabricante se reserva el derecho a realizar cambios (incluido el cambio en los parámetros técnicos con referencia a las medidas concretas del modelo).
- (DE)** Die Informationen hinsichtlich der technischen Daten, Design, Ausstattung, Materialien, Garantie und des äußerlichen Erscheinungsbildes beziehen sich auf den Zeitpunkt der Drucklegung der Montageanleitung. Der Hersteller behält sich das Recht auf Änderungen vor (einschließlich Änderungen von technischen Parametern bezüglich der Abmessungen der einzelnen Modelle).
- (GB)** The information on the technical data, design, equipment, materials, guarantees and outside appearance refer to the period when the mounting instructions are sent to print. The manufacturer reserves the right to changes (including the change in technical parameters with reference to the individual model measures).
- Standard marking for car wash and warnings (dealer monting only...)
- (IT)** Le informazioni sui dati tecnici, la progettazione, le apparecchiature, i materiali, le garanzie e l'aspetto esteriore fanno riferimento al periodo della messa in stampa delle istruzioni di montaggio. Il produttore si riserva il diritto di apportare modifiche (ivi compresa la modifica dei parametri tecnici con riferimento alle misure dei singoli modelli).
- (FR)** Les informations concernant les données techniques, la conception, l'équipement, les matériaux, les garanties et l'apparence extérieure font référence au moment où les instructions de montage ont été envoyées à l'impression. Le fabricant se réserve le droit d'effectuer des modifications (y compris de changer des paramètres techniques en référence aux dimensions d'un modèle).
- (RU)** Информация о технических характеристиках, дизайне, оборудовании, материалах, гарантиях и внешнем виде приведена на момент печати инструкции по монтажу. Производитель оставляет за собой право на изменения (в том числе изменения технических параметров с указанием их масштабов для конкретной модели).
- (GR)** Οι πληροφορίες για τα τεχνικά χαρακτηριστικά, το σχεδιασμό, τον εξοπλισμό, τα υλικά, την εγγύηση και τον εξωτερικό σχεδιασμό αναφέρονται στο χρόνο αποστολής των οδηγιών εγκατάστασης προς εκτύπωση. Ο κατασκευαστής διατηρεί το δικαίωμα αλλαγών (συμπεριλαμβανομένων των αλλαγών στις τεχνικές προδιαγραφές που σχετίζονται με τις διαστάσεις κάθε μοντέλου).
- (PT)** As informações sobre os dados técnicos, conceção, equipamento, materiais, garantias e aparência externa estão corretas no momento da impressão das instruções de montagem. O fabricante reserva-se o direito de realizar alterações (incluindo a alteração de parâmetros técnicos relativos às medidas do modelo específico).
- (NL)** De informatie over technische gegevens, ontwerp, uitrusting, materialen, garanties en buitenaanzicht verwijst naar het tijdstip waarop de montage-instructies verzonden zijn voor afdruk. De fabrikant behoudt zich het recht voor om wijzigingen aan te brengen (inclusief het aanpassen van de technische parameters met betrekking tot de individuele modelmaten).
- (CZ)** Informace týkající se technických údajů, provedení, vybavení, materiálů, záruk a fyzického vzhledu jsou aktuální v době, kdy jsou tyto montážní pokyny odesílány do tisku. Výrobce si vyhrazuje právo tyto údaje kdykoliv změnit (včetně technických parametrů jednotlivých modelů).
- (PL)** Informacje na temat danych technicznych, budowy, wyposażenia, materiałów, gwarancji oraz wyglądu zewnętrznego są aktualne na dzień wysłania instrukcji montażu do druku. Producent zastrzega sobie prawo do zmian (w tym zmian parametrów technicznych dotyczących poszczególnych modeli).
- (CN)** 关于技术数据、设计、设备、材料、保证和外观的信息适用于发送安装说明以备打印之时。制造商保留更改信息的权利 (包括按照个别模型尺寸对技术参数进行变更)。